

2001
Carroll County, Iowa
Iowa North Zone (1401)
NAD_83(1996)

Point Number: 5

Northing: 3480282.94(Ft) Easting: 4488917.95(Ft)

Northing: 1060792.362(M) Easting: 1368224.928(M)

Elev: 1474.79(Ft) NAVD_88

Elev: 449.516(M) NAVD_88 Ellip Ht: 420.426(M) 96C Geoid Ht: -29.089(M)

Latitude: 42-02-10.081193 N Longitude: 95-05-29.388797 W

Theta: -1-04-43.06 Combination Factor: 0.99993971

Designation: **CARROLL CO GPS CONTROL PT 2001-005**

Monument Type: 5/8" dia driven aluminum rod with a 2-1/2" dia aluminum cap and permanent magnet encased in a 5" dia PVC pipe with an aluminum access cover.

Remarks: Located near the SW Cor of Sec 31 T84N R36W.

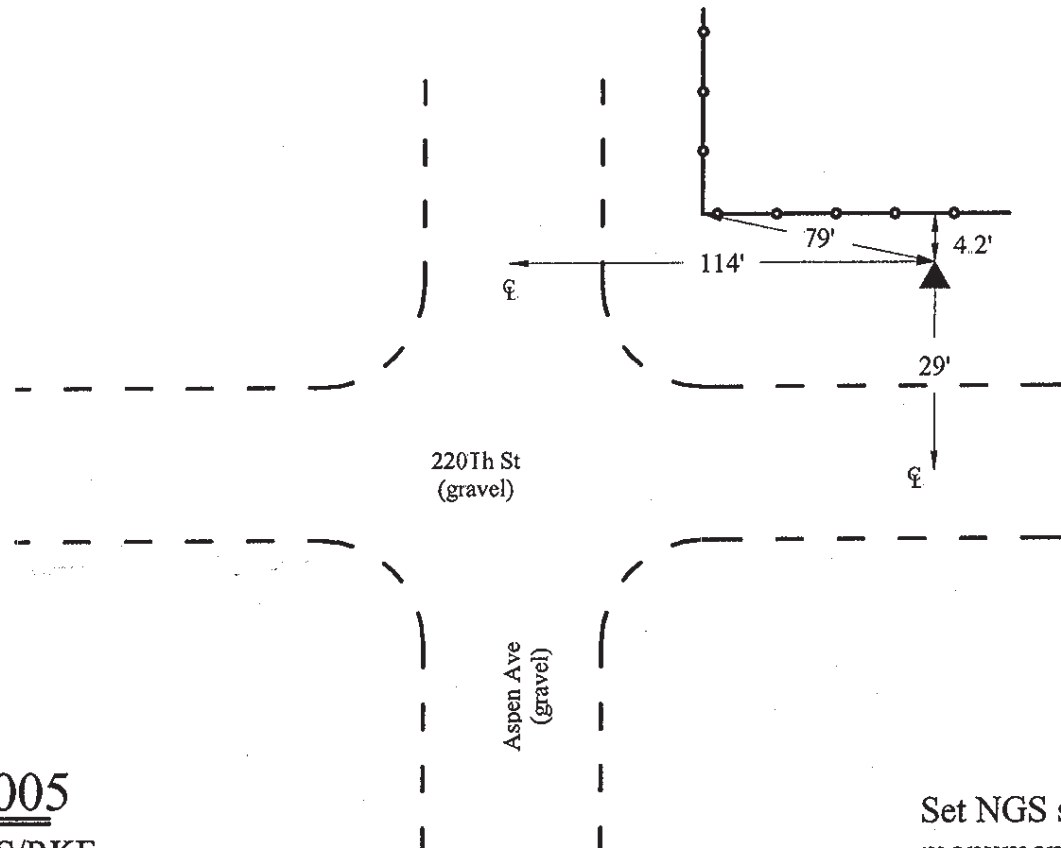

2001-005
BRS/SBS/RKE
March 27, 2001

Set NGS style rod
monument with
access cover