

2001
Carroll County, Iowa
Iowa North Zone (1401)
NAD_83(1996)

Point Number: 47

Northing: 3434260.42(Ft) Easting: 4566653.45(Ft)

Northing: 1046764.671(M) Easting: 1391918.755(M)

Elev: 1280.69(Ft) NAVD_88

Elev: 390.356(M) NAVD_88 Ellip Ht: 362.425(M) 96C Geoid Ht: -27.932(M)

Latitude: 41-54-48.646235 N Longitude: 94-48-09.998812 W

Theta: -0-52-58.62 Combination Factor: 0.99997445

Designation: CARROLL CO GPS CONTROL PT 2001-047

Monument Type: 5/8" dia driven aluminum rod with a 2-1/2" dia aluminum cap and permanent magnet encased in a 5" dia PVC pipe with an aluminum access cover.

Remarks: Located near the W 1/4 Cor of Sec 15 T82N R34W.

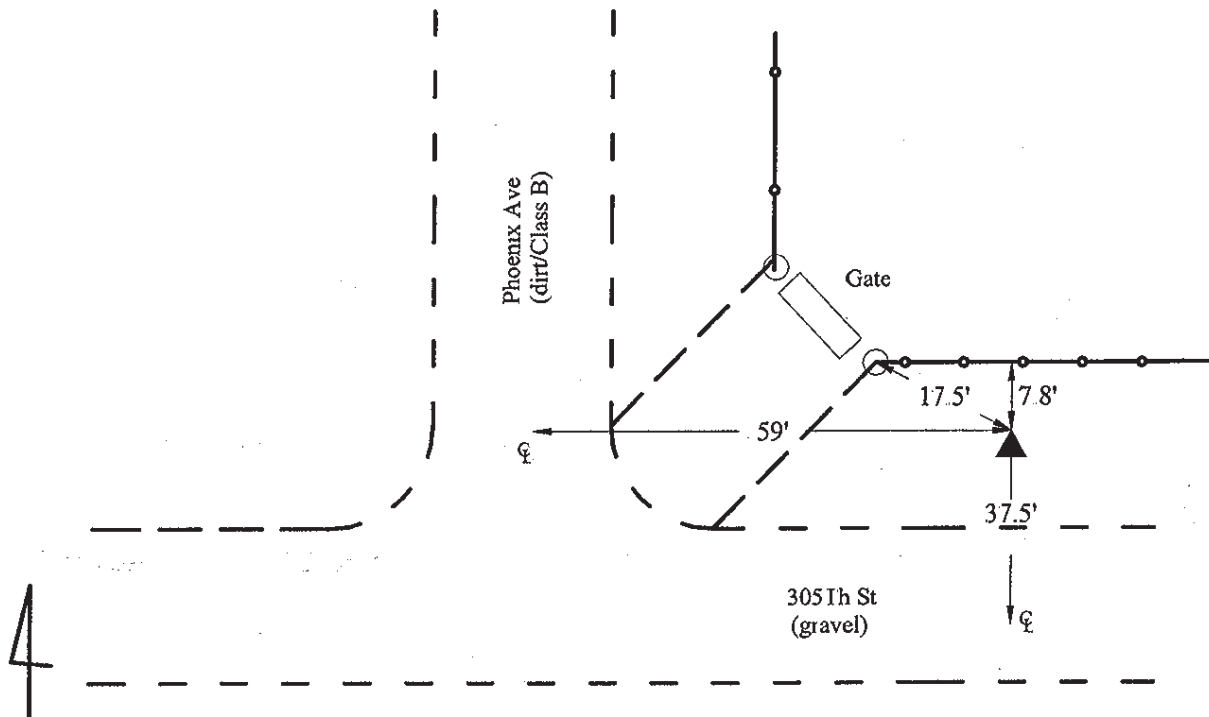

2001-047

BRS/RKE/SBS
March 29, 2001

Set NGS style rod
monument with
access cover