

2001
Carroll County, Iowa
Iowa North Zone (1401)
NAD_83(1996)

Point Number: 61

Northing: 3510345.33(Ft) Easting: 4583648.44(Ft)

Northing: 1069955.395(M) Easting: 1397098.837(M)

Elev: 1199.45(Ft) NAVD_88

Elev: 365.592(M) NAVD_88 Ellip Ht: 337.154(M) 96C Geoid Ht: -28.438(M)

Latitude: 42-07-22.715907 N Longitude: 94-44-40.063860 W

Theta: -0-50-36.34 Combination Factor: 0.99993735

Designation: CARROLL CO GPS CONTROL PT 2001-061

Monument Type: 5/8" dia driven aluminum rod with a 2-1/2" dia aluminum cap and permanent magnet encased in a 5" dia PVC pipe with an aluminum access cover.

Remarks: Located near the NW Cor of Sec 6 T84N R33W.

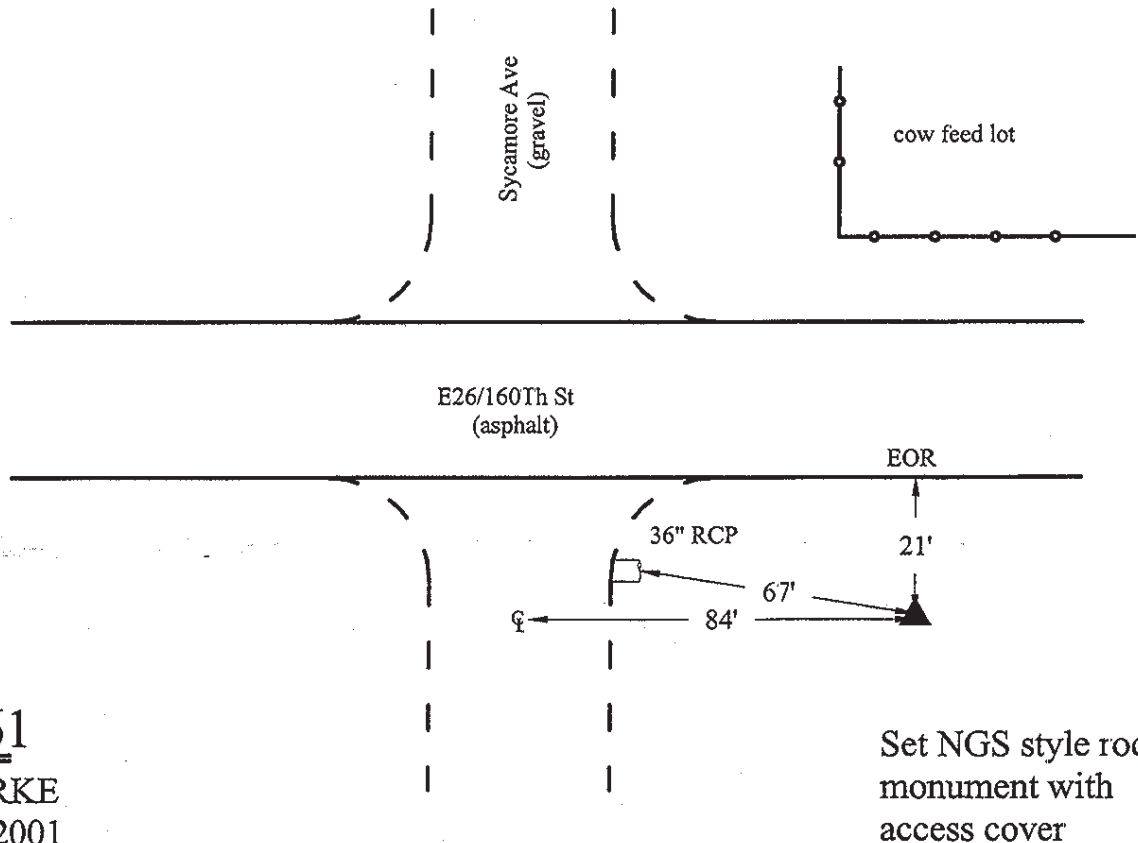

2001-061

BRS/SBS/RKE
March 28, 2001

Set NGS style rod
monument with
access cover