

2001
Carroll County, Iowa
Iowa North Zone (1401)
NAD_83(1996)

Point Number: 64

Northing: 3414671.17(Ft) Easting: 4600602.77(Ft)

Northing: 1040793.855(M) Easting: 1402266.528(M)

Elev: 1158.22(Ft) NAVD_88

Elev: 353.025(M) NAVD_88 Ellip Ht: 325.575(M) 96C Geoid Ht: -27.450(M)

Latitude: 41-51-40.068827 N Longitude: 94-40-37.429059 W

Theta: -0-47-51.89 Combination Factor: 0.99999256

Designation: **CARROLL CO GPS CONTROL PT 2001-064**

Monument Type: 5/8" dia driven aluminum rod with a 2-1/2" dia aluminum cap and permanent magnet encased in a 5" dia PVC pipe with an aluminum access cover.

Remarks: Located near the S 1/4 Cor of Sec 34 T82N R33W.

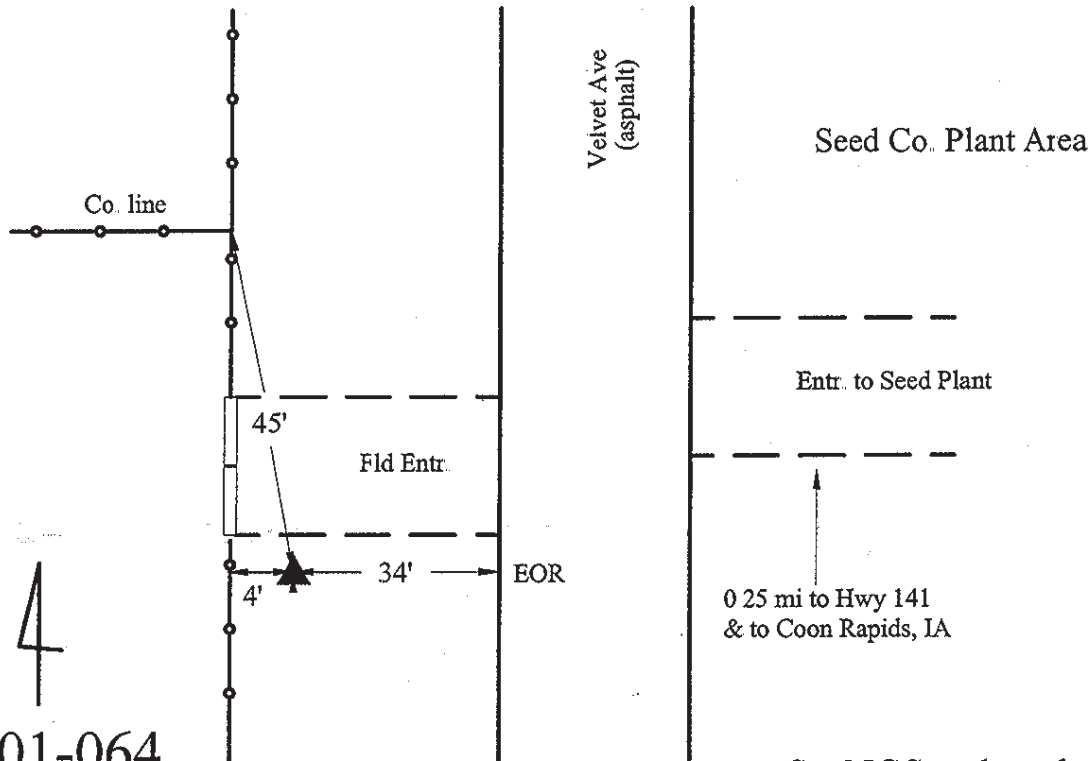

2001-064

BRS/SBS/RKE
March 28, 2001

Set NGS style rod
monument with
access cover