

Cedar County, Iowa
Horizontal Datum: **NAD 83(2011)** - Vertical Datum: **NAVD 1988**
Iowa State Plane South Zone (1402)
Iowa Regional Coordinate System, Zone 10. Cedar Rapids (LCC)
US Survey Feet
2015

Point Name: **3**

Designation: CBN horizontal control station "95 03" PID: AE2145

NAD 83(NA2011) Latitude: **N41°51'07.34272"** Longitude: **W90°59'54.93793"**
NAVD 88 Ortho Height: **828.32sft** Ellip. Ht: **721.30sft** **Geoid12A**

Iowa South Zone (1402) Northing: **684581.49sft** Easting: **2321835.44sft**
Mapping Angle: **1°38'52"** Combination Scale Factor: **0.999978505**

IaRCS Zone 10 Northing: **8007524.536sft** Easting: **20682017.126sft**
Mapping Angle: **00° 26' 44"** Combination Scale Factor: **0.999985507**

Monument Type: Berntsen driven aluminum rod with a stamped survey cap, encased in a white PVC pipe with a NGS style alum. access cover.

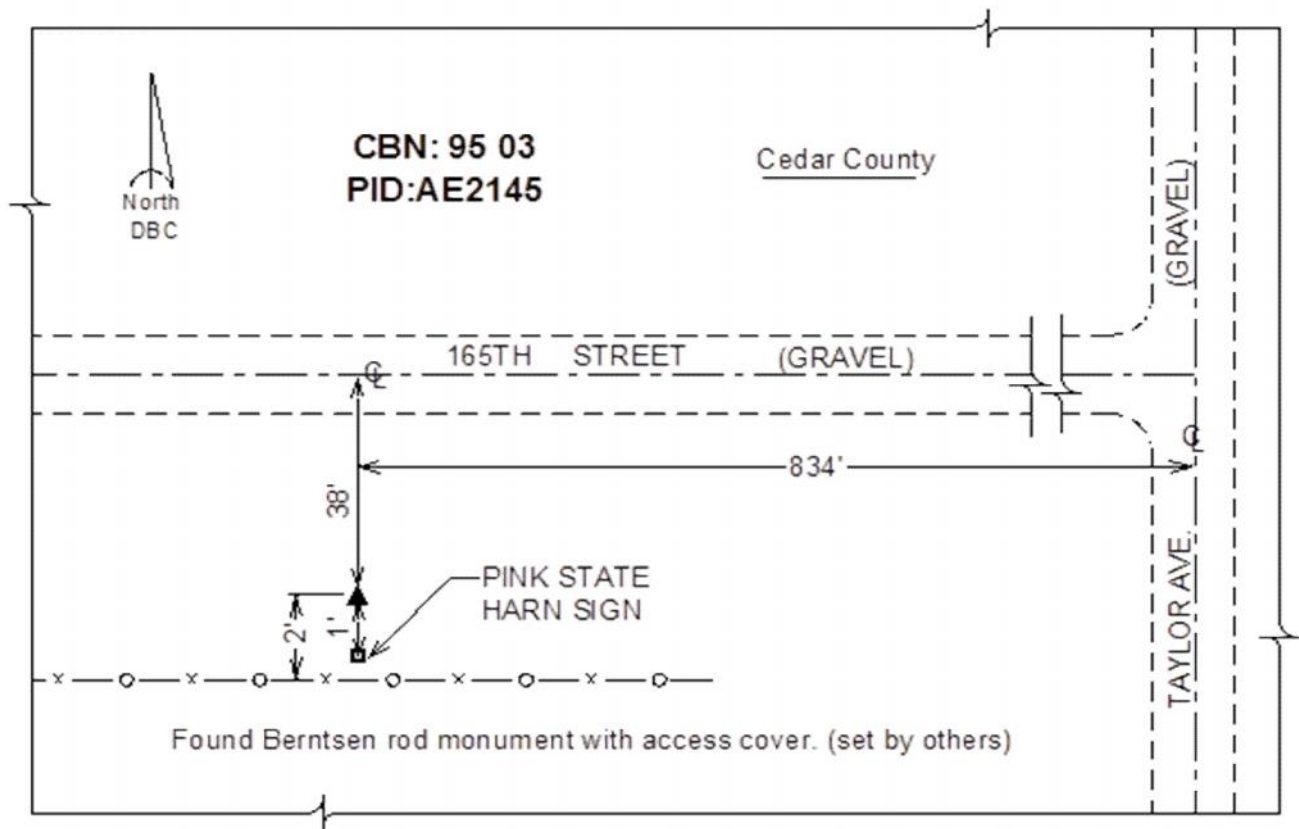

This document was prepared by Dan Corbin, Inc. on September 30, 2015 for Cedar County, Iowa.