

**Cedar County, Iowa**  
Horizontal Datum: **NAD 83(2011)** - Vertical Datum: **NAVD 1988**  
Iowa State Plane South Zone (1402)  
Iowa Regional Coordinate System, Zone 10. Cedar Rapids (LCC)  
US Survey Feet  
**2015**

Point Name: **6005**

**Designation:** NGS 2nd order vertical control station "G 70" PID: MG0328

NAD 83(NA2011) Latitude: **N41°38'44.62276"** Longitude: **W90°34'51.08685"**  
NAVD 88 Ortho Height: **780.10sft** Ellip. Ht: **672.37sft** **Geoid12A**

**Iowa South Zone (1402)** Northing: **612990.78sft** Easting: **2438115.66sft**  
Mapping Angle: **1°55'22"** Combination Scale Factor: **0.999946382**

**IaRCS Zone 10** Northing: **7933511.602sft** Easting: **20796775.181sft**  
Mapping Angle: **00° 43' 27"** Combination Scale Factor: **0.999993131**

**Monument Type:** The station is a CGS brass disk stamped "G 70 1934" and set in the top of and near the north end of the east concrete headwall of a 3'x3' box culvert.

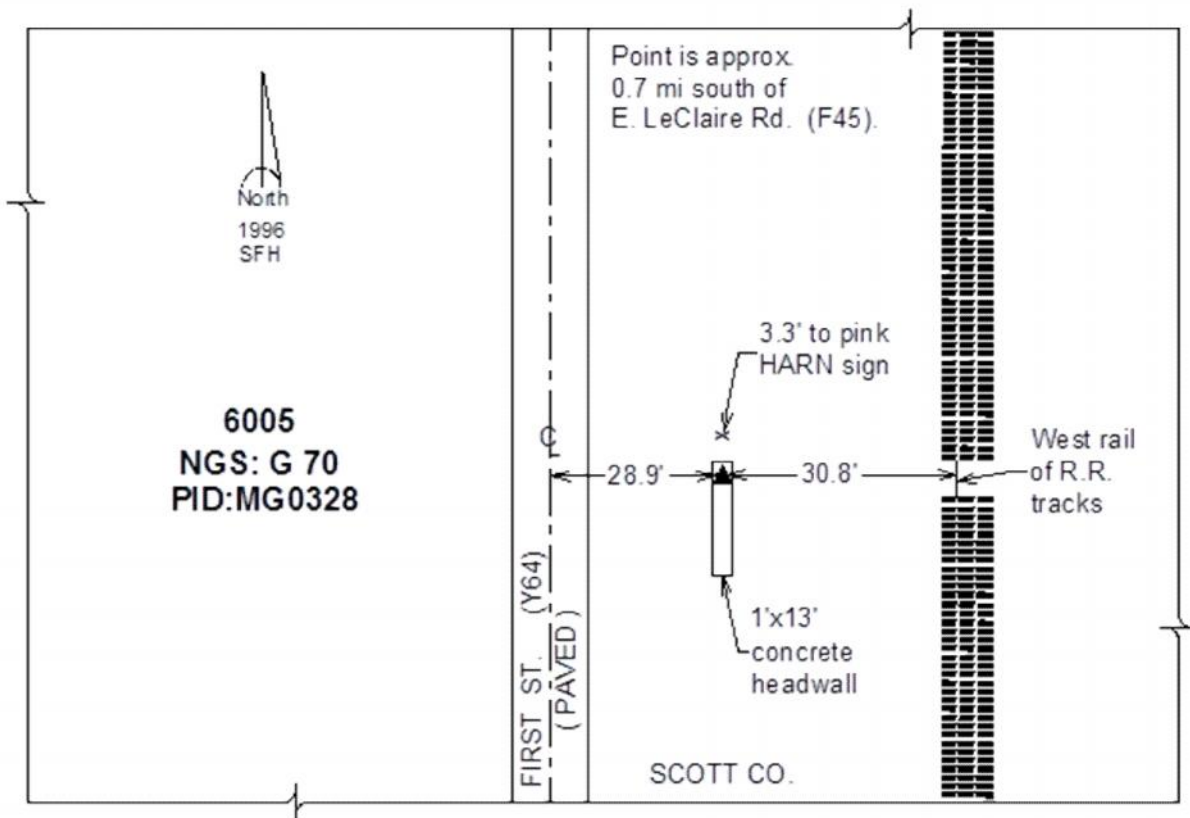

*This document was prepared by Dan Corbin, Inc. on September 30, 2015 for Cedar County, Iowa.*