

Cedar County, Iowa
Iowa South Zone (1402)
Horiz. Datum: NAD83(NSRS2007)
Vert. Datum: NAVD 1988
US Survey Feet
2008

Point Name: **5020**

Designation: 2000-101 Muscatine Co GPS Control Pt (Set by ASI in 2000)

Northing: **590473.00**sft Easting: **2284651.92**sft

Orthometric Height: **736.52**sft Ellipsoid Height: **629.33**sft **Geoid03**

Latitude: **41°35'48.21786"N** Longitude: **91°08'39.74796"W**

Mapping Angle: **1°33'06"** Combination Scale Factor: **0.999994216**

Monument Type: 5/8" dia. driven aluminum rod with a 2-1/2" dia. aluminum cap and permanent magnet encased in a 5" dia. PVC pipe with an aluminum access cover.

To Reach: 20ft W of Lotus Ave, approx. 0.75 mi N of 102nd near the N 1/4 cor Sec 1 T78N R3W.

Date Printed August 9, 2000

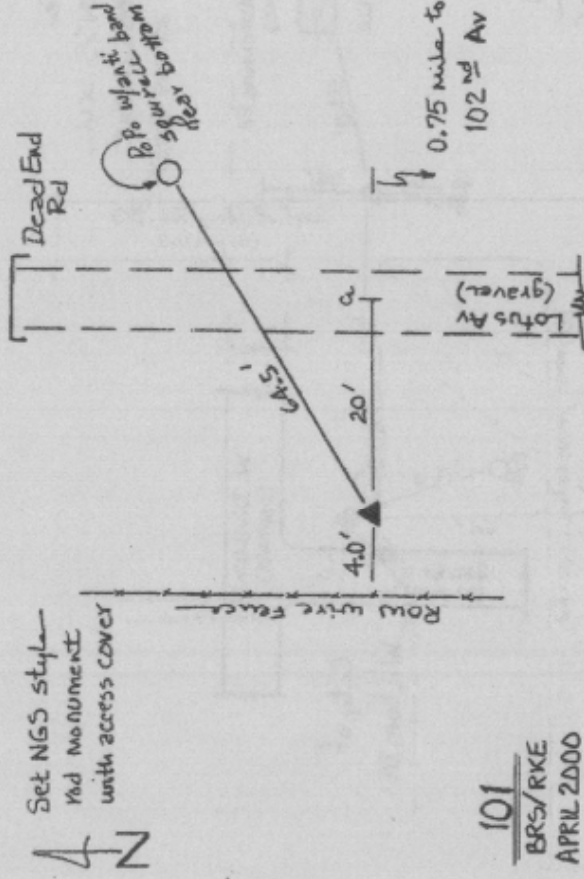

101
BRS/RKE
APRIL 2000