

Cerro Gordo County, Iowa
Iowa North Zone (1401)
Horiz. Datum: **NAD83(NA2011)**
Vert. Datum: NAVD 1988
US Survey Feet
2013

Point Name: **16**

Designation: G16 (97-016 Hancock Co GPS Control Pt. Set by ASI in 1997)

Northing: **3889174.72sft** Easting: **4921849.63sft**

Orthometric Height: **1246.23sft** Ellipsoid Height: **1150.99sft** **Geoid12A**

Latitude: **N43°10'09.41001"** Longitude: **W93°29'51.90858"**

Mapping Angle: **0°00'05"** Combination Scale Factor: **0.999928746**

Monument Type: 5/8" dia driven aluminum rod with a 2-1/2" dia aluminum cap and permanent magnet encased in a 5" dia PVC pipe with an aluminum access cover.

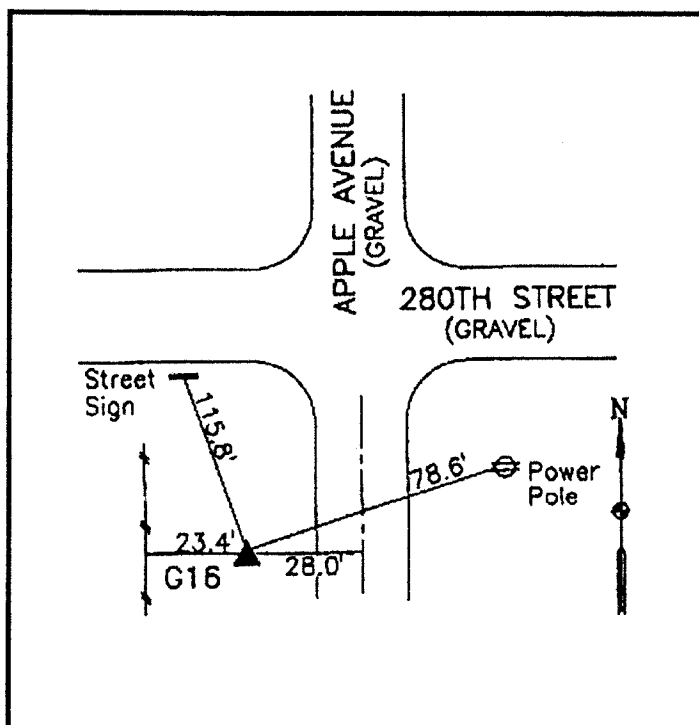

30' West of Apple Avenue -
140' South of 280th Street -
near the NE Corner of Section
1-T96N-R23W.

WHKS & CO.

This document was prepared by DCI on 09-30-2013 for use by Cerro Gordo County, Iowa.