

Cerro Gordo County, Iowa
Iowa North Zone (1401)
Horiz. Datum: NAD83(NA2011)
Vert. Datum: NAVD 1988
US Survey Feet
2013

Point Name: 38

Designation: G38 (97-038 Hancock Co GPS Control Pt. Set by ASI in 1997)

Northing: 3825764.51sft Easting: 4921823.51sft

Orthometric Height: 1226.21sft Ellipsoid Height: 1133.45sft **Geoid12A**

Latitude: N42°59'43.08781" Longitude: W93°29'52.28265"

Mapping Angle: 0°00'05" Combination Scale Factor: 0.999907612

Monument Type: 5/8" dia driven aluminum rod with a 2-1/2" dia aluminum cap and permanent magnet encased in a 5" dia PVC pipe with an aluminum access cover.

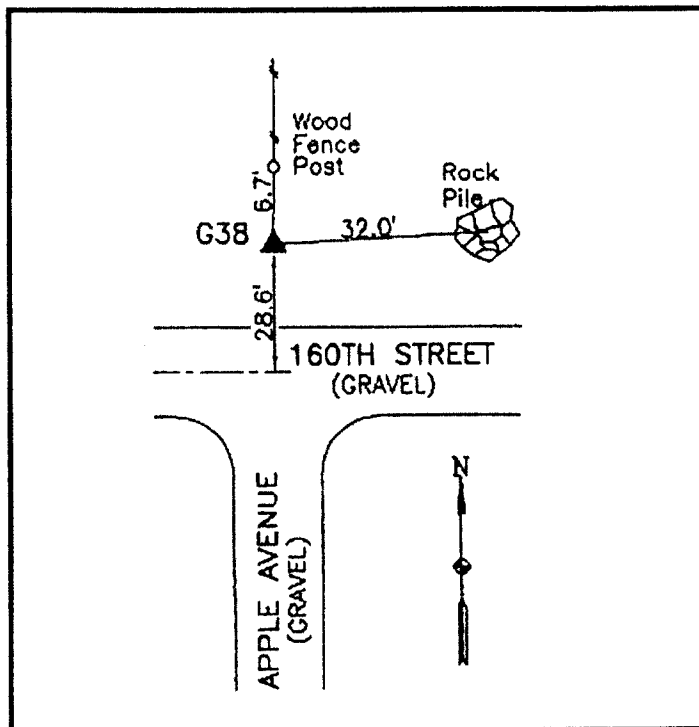

25' North of 160th Street at "T" intersection of Apple Avenue to south - near the SE Corner of Section 36-T95N-R23W.

WHKS & CO.

This document was prepared by DCI on 09-30-2013 for use by Cerro Gordo County, Iowa.