

Cerro Gordo County, Iowa
Iowa North Zone (1401)
Horiz. Datum: NAD83(NA2011)
Vert. Datum: NAVD 1988
US Survey Feet
2013

Point Name: 101

Designation: G101 (98-101 Butler Co GPS Control Pt. Set by ASI in 1998)

Northing: 3794097.26sft Easting: 5048492.82sft

Orthometric Height: 1090.83sft Ellipsoid Height: 991.19sft Geoid12A

Latitude: N42°54'26.75844" Longitude: W93°01'30.19308"

Mapping Angle: 0°19'19" Combination Scale Factor: 0.999906815

Monument Type: 5/8" dia driven aluminum rod with a 2-1/2" dia aluminum cap and permanent magnet encased in a 5" dia PVC pipe with an aluminum access cover.

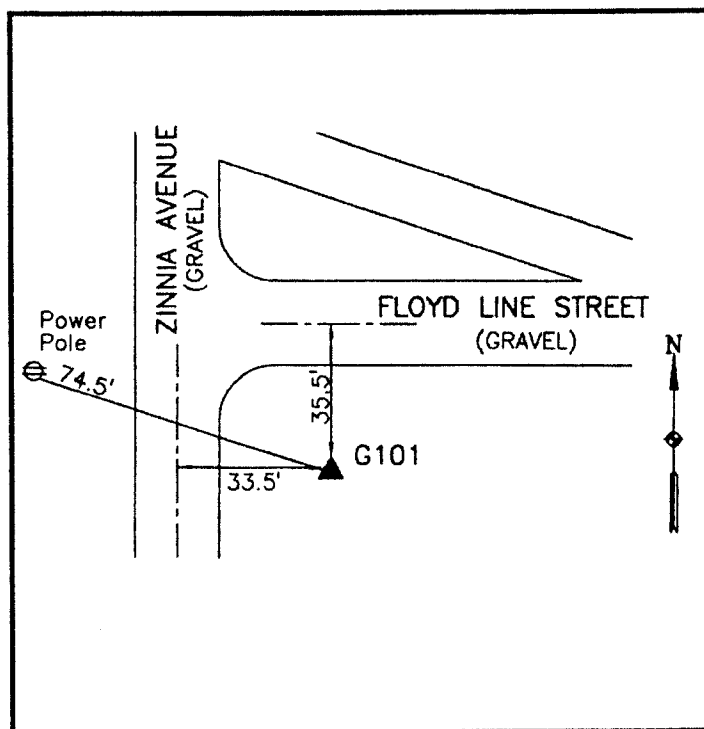

30' south of Floyd Line Street -
30' east of Zinnia Avenue -
near the NW Corner of Section
6-T93N-R18W.

WHKS & CO.

This document was prepared by DCI on 09-30-2013 for use by Cerro Gordo County, Iowa.