

Cerro Gordo County, Iowa
Iowa North Zone (1401)
Horiz. Datum: **NAD83(NA2011)**
Vert. Datum: NAVD 1988
US Survey Feet
2013

Point Name: **105**

Designation: G105 (Set by WHKS & Co. in 2002)

Northing: **3793978.42sft** Easting: **4984991.67sft**

Orthometric Height: **1106.77sft** Ellipsoid Height: **1013.94sft** **Geoid12A**

Latitude: **N42°54'28.22928"** Longitude: **W93°15'43.47822"**

Mapping Angle: **0°09'41"** Combination Scale Factor: **0.999905759**

Monument Type: 5/8" x 6'-0" long aluminum rod with cap stamped G105 and NGS style access cover 1" deep.

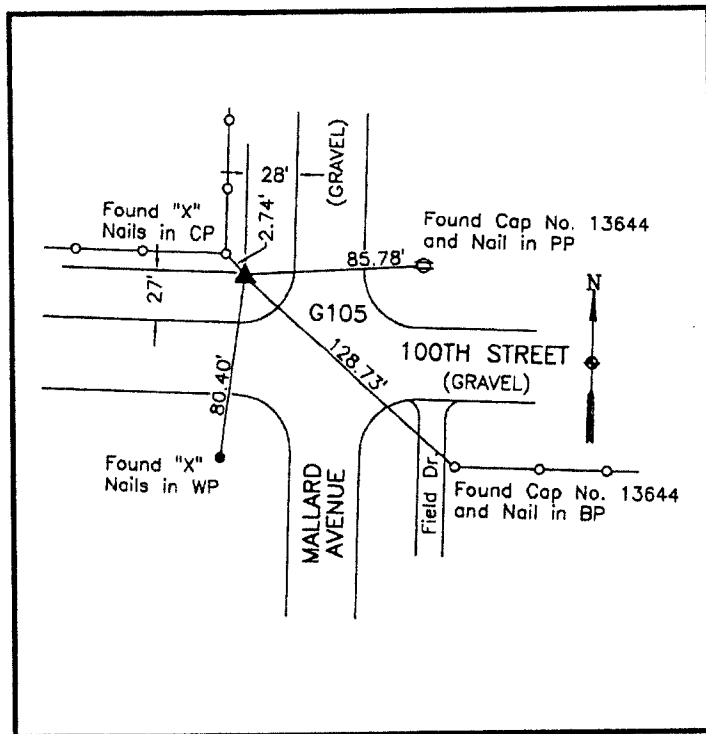

NW Corner Mallard Avenue
and 100th Street - 2'± south
and 1'± east of wood corner
post - near SW Corner Section
31-T94N-R20W.

WHKS & CO.

This document was prepared by DCI on 09-30-2013 for use by Cerro Gordo County, Iowa.