

Cerro Gordo County, Iowa  
Iowa North Zone (1401)  
Horiz. Datum: **NAD83(NA2011)**  
Vert. Datum: NAVD 1988  
US Survey Feet  
**2013**

Point Name: **124**

**Designation:** G124 (Set by WHKS & Co. in 2002)

Northing: **3841466.17sft** Easting: **4953594.46sft**

Orthometric Height: **1261.93sft** Ellipsoid Height: **1169.92sft** **Geoid12A**

Latitude: **N43°02'17.95241"**

Longitude: **W93°22'44.46076"**

Mapping Angle: **0°04'55"**

Combination Scale Factor: **0.999910444**

**Monument Type:** 5/8" x 6'-0" long aluminum rod with cap stamped G124 and NGS style access cover 3" deep.

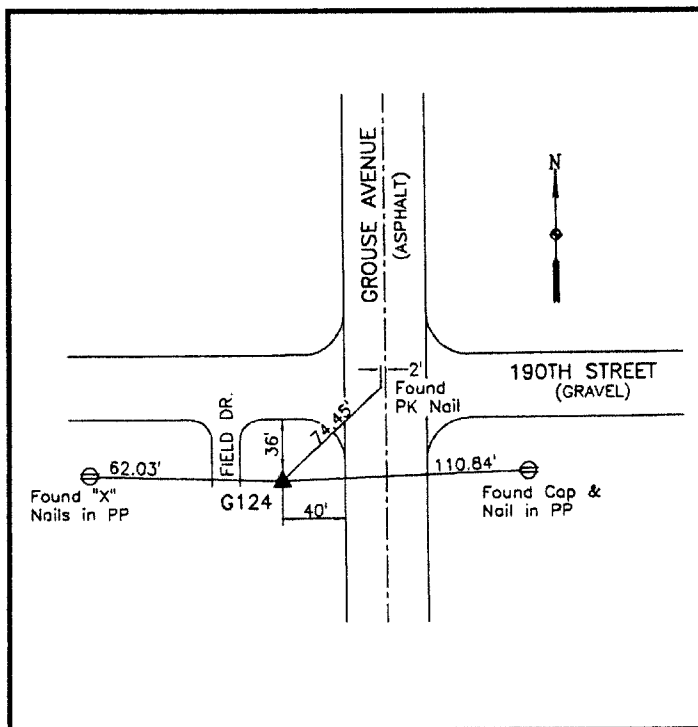

SW Corner Grouse Avenue  
and 190th Street - near NW  
Corner Section 19-T95N-  
R21W.

**WHKS & CO.**

*This document was prepared by DCI on 09-30-2013 for use by Cerro Gordo County, Iowa.*