

Cerro Gordo County, Iowa
Iowa North Zone (1401)
Horiz. Datum: **NAD83(NA2011)**
Vert. Datum: NAVD 1988
US Survey Feet
2013

Point Name: **128**

Designation: G128 (Set by WHKS & Co. in 2002)

Northing: **3841294.82sft** Easting: **5016936.38sft**

Orthometric Height: **1184.29sft** Ellipsoid Height: **1089.43sft** **Geoid12A**

Latitude: **N43°02'14.48782"** Longitude: **W93°08'31.53727"**

Mapping Angle: **0°14'33"** Combination Scale Factor: **0.999914176**

Monument Type: 5/8" x 6'-0" long aluminum rod with cap stamped G128 and NGS style access cover 1" deep.

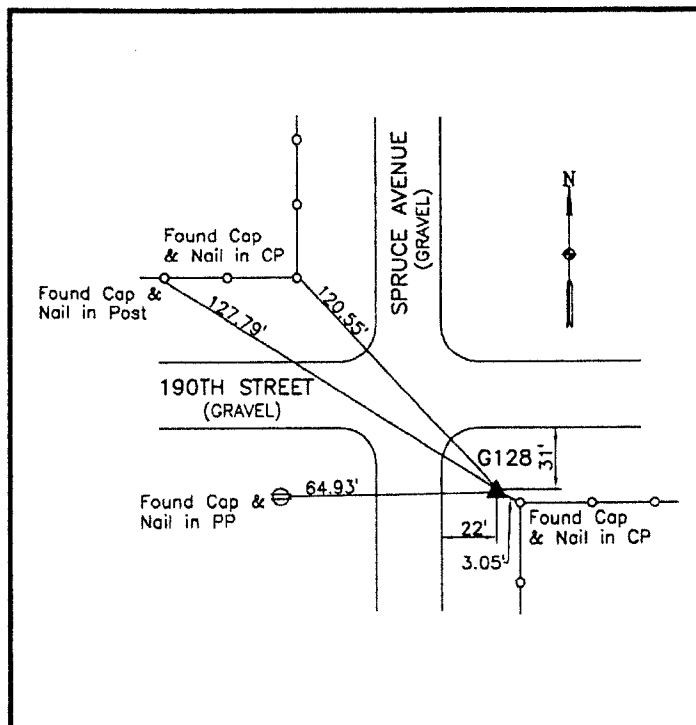

SW Corner Spruce Avenue
and 190th Street - 2'± north
and 2'± west of corner post -
near NW Corner Section 19-
T95N-R19W.

WHKS & CO.

This document was prepared by DCI on 09-30-2013 for use by Cerro Gordo County, Iowa.