

**Cerro Gordo County, Iowa**  
Iowa North Zone (1401)  
Horiz. Datum: **NAD83(NA2011)**  
Vert. Datum: NAVD 1988  
US Survey Feet  
**2013**

Point Name: **134**

**Designation:** G134 (Set by WHKS & Co. in 2002)

Northing: **3857823.26sft** Easting: **4970574.26sft**

Orthometric Height: **1185.69sft** Ellipsoid Height: **1093.47sft** **Geoid12A**

Latitude: **N43°04'59.21415"**

Longitude: **W93°18'55.33632"**

Mapping Angle: **0°07'30"**

Combination Scale Factor: **0.999919453**

**Monument Type:** 5/8" x 6'-0" long aluminum rod with cap stamped G134 and NGS style access cover 3" deep.

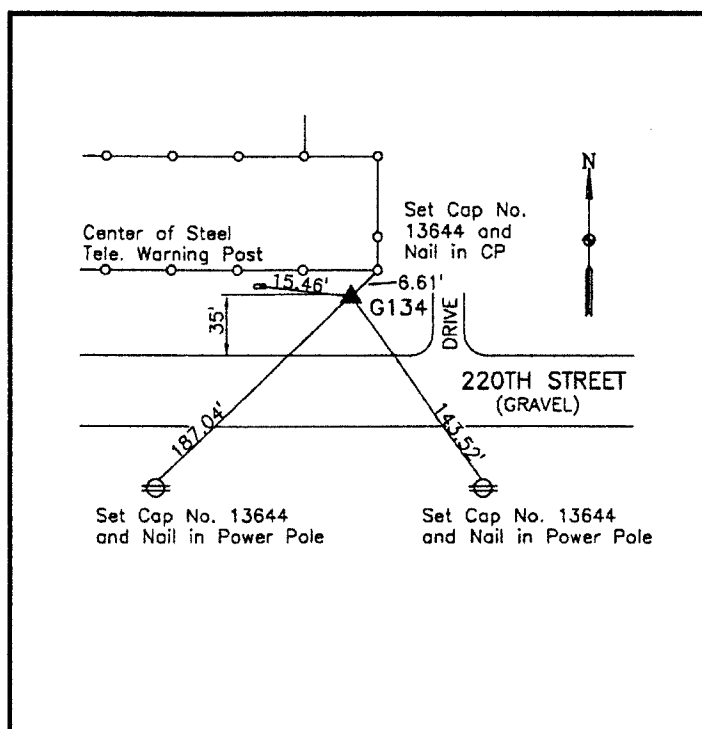

North side of 220th Street -  
0.25± mile east of Jonquil  
Avenue - west side of field  
entrance - 6'± west of a corner  
post - near NW Corner Section  
3-T95N-R21W.

**WHKS & CO.**

*This document was prepared by DCI on 09-30-2013 for use by Cerro Gordo County, Iowa.*