

Cerro Gordo County, Iowa
Iowa North Zone (1401)
Horiz. Datum: **NAD83(NA2011)**
Vert. Datum: NAVD 1988
US Survey Feet
2013

Point Name: **135**

Designation: G135 (Set by WHKS & Co. in 2002)

Northing: **3859024.04sft** Easting: **4953725.04sft**

Orthometric Height: **1259.04sft** Ellipsoid Height: **1166.56sft** **Geoid12A**

Latitude: **N43°05'11.37597"** Longitude: **W93°22'42.36248"**

Mapping Angle: **0°04'57"** Combination Scale Factor: **0.999916395**

Monument Type: 5/8" x 6'-0" long aluminum rod with cap stamped G135 and NGS style access cover 2" deep.

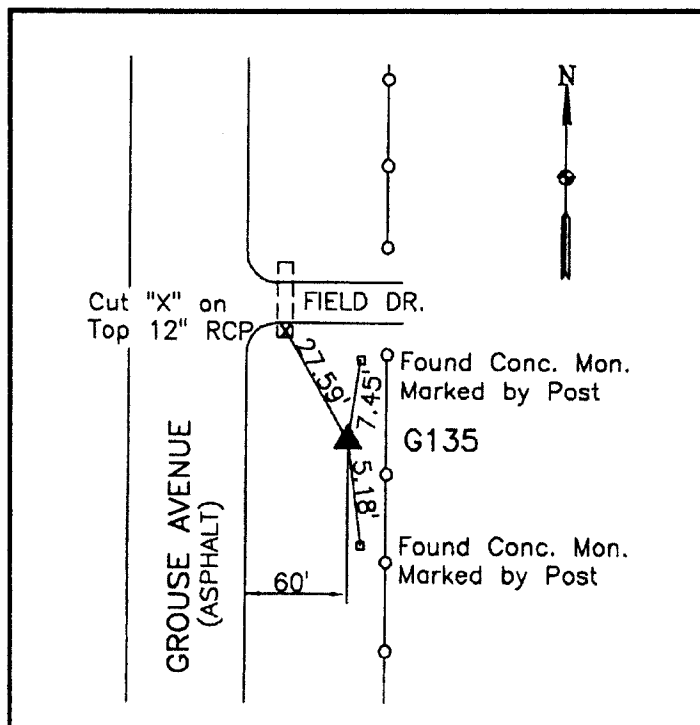

East side Grouse Avenue -
0.2± mile north of 220th street -
south side of a field entrance -
20'± south of gate post - near
NW Corner Section 6-T95N-
R21W.

WHKS & CO.

This document was prepared by DCI on 09-30-2013 for use by Cerro Gordo County, Iowa.