

Cerro Gordo County, Iowa
Iowa North Zone (1401)
Horiz. Datum: **NAD83(NA2011)**
Vert. Datum: NAVD 1988
US Survey Feet
2013

Point Name: **140**

Designation: G140 (Set by WHKS & Co. in 2002)

Northing: **3873683.21sft** Easting: **4985005.79sft**

Orthometric Height: **1188.34sft** Ellipsoid Height: **1095.80sft** **Geoid12A**

Latitude: **N43°07'35.50927"**

Longitude: **W93°15'40.26294"**

Mapping Angle: **0°09'43"**

Combination Scale Factor: **0.999925122**

Monument Type: 5/8" x 6'-0" long aluminum rod with cap stamped G140 and NGS style access cover 2" deep.

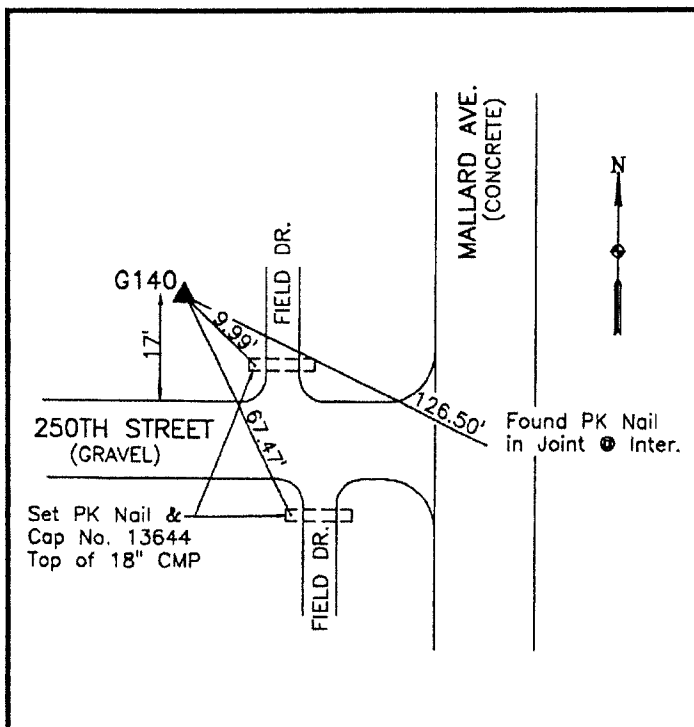

North side of 250th Street -
150'± west of Mallard Avenue -
20'± west of a field entrance -
near NW Corner Section 19-
T96N-R20W.

WHKS & CO.

This document was prepared by DCI on 09-30-2013 for use by Cerro Gordo County, Iowa.