

Cerro Gordo County, Iowa
Iowa North Zone (1401)
Horiz. Datum: **NAD83(NA2011)**
Vert. Datum: NAVD 1988
US Survey Feet
2013

Point Name: **305**

Designation: G305 (2000-305 Floyd Co GPS Control Pt. Set by ASI in 2000)

Northing: **3841854.93sft** Easting: **5048410.58sft**

Orthometric Height: **1050.59sft** Ellipsoid Height: **952.30sft** **Geoid12A**

Latitude: **N43°02'18.48761"**

Longitude: **W93°01'27.68745"**

Mapping Angle: **0°19'21"**

Combination Scale Factor: **0.999920843**

Monument Type: 5/8" dia driven aluminum rod with a 2-1/2" dia aluminum cap and permanent magnet encased in a 5" dia PVC pipe with an aluminum access cover.

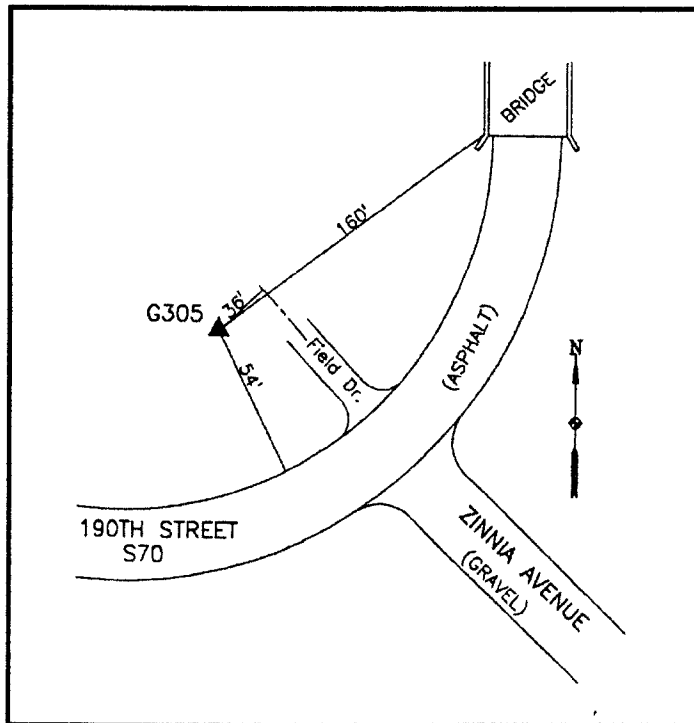

55' NW of curve in County Road "B 47" - 35' SW of field entrance - to NW in the SE1/4 of Section 13-T95N-R19W.

WHKS & CO.

This document was prepared by DCI on 09-30-2013 for use by Cerro Gordo County, Iowa.