

Cerro Gordo County, Iowa
Iowa North Zone (1401)
Horiz. Datum: **NAD83(NA2011)**
Vert. Datum: NAVD 1988
US Survey Feet
2013

Point Name: **403**

Designation: G3MC (Set by WHKS & Co. in 2002)

Northing: **3876266.25sft** Easting: **4990522.66sft**

Orthometric Height: **1176.48sft** Ellipsoid Height: **1083.81sft** **Geoid12A**

Latitude: **N43°08'00.86163"**

Longitude: **W93°14'25.76236"**

Mapping Angle: **0°10'33"**

Combination Scale Factor: **0.999926687**

Monument Type: 5/8" x 6'-0" long aluminum rod with cap stamped G3MC and NGS style access cover 3" deep.

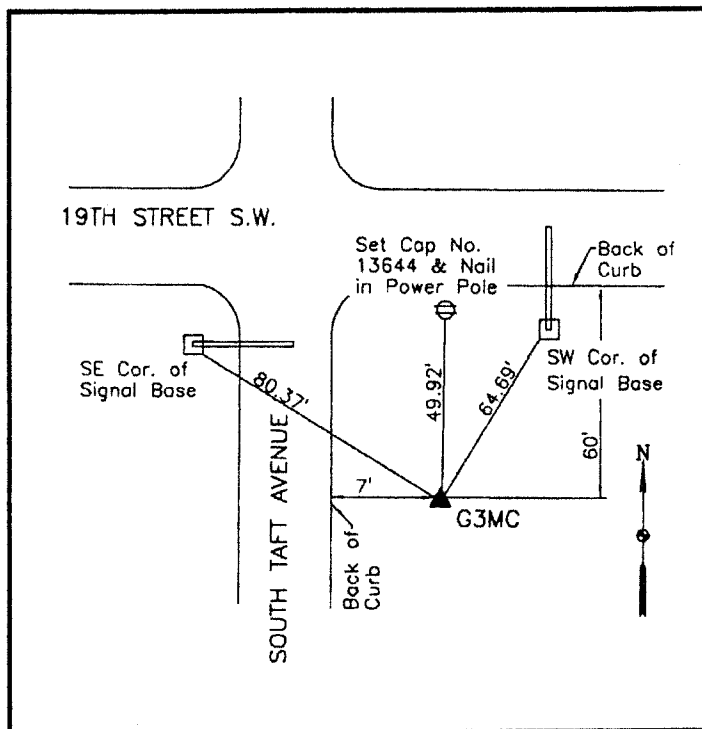

SE Corner 19th Street SW and
South Taft Avenue - near NW
Corner Section 17-T96N-
R20W.

WHKS & CO.

This document was prepared by DCI on 09-30-2013 for use by Cerro Gordo County, Iowa.