

**Cerro Gordo County, Iowa**  
Iowa North Zone (1401)  
Horiz. Datum: **NAD83(NA2011)**  
Vert. Datum: NAVD 1988  
US Survey Feet  
**2013**

Point Name: **405**

**Designation:** G5MC (Set by WHKS & Co. in 2002)

Northing: **3876334.99sft** Easting: **5001678.30sft**

Orthometric Height: **1160.79sft** Ellipsoid Height: **1067.68sft** **Geoid12A**

Latitude: **N43°08'01.17512"**

Longitude: **W93°11'55.31099"**

Mapping Angle: **0°12'15"**

Combination Scale Factor: **0.999927469**

**Monument Type:** 5/8" x 6'-0" long aluminum rod with cap stamped G5MC and NGS style access cover 4" deep.

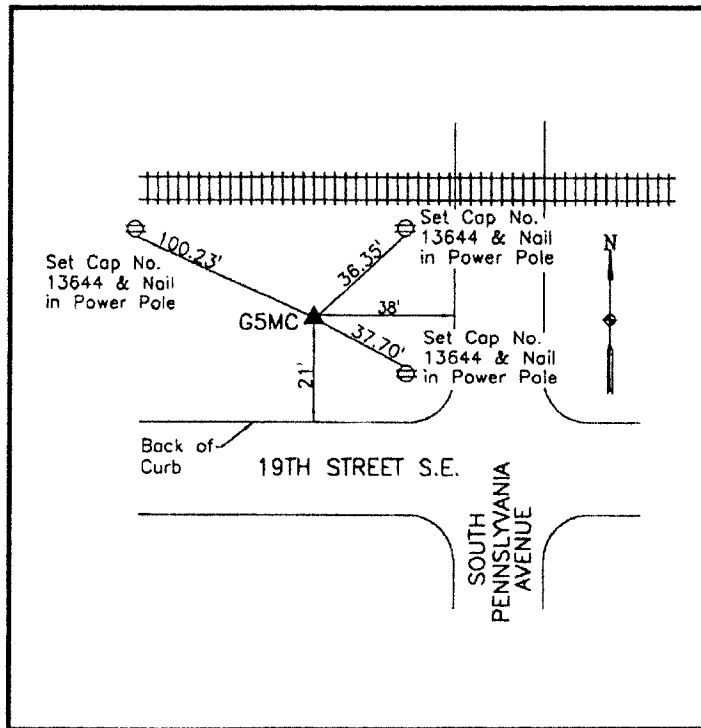

NW Corner South  
Pennsylvania Avenue and 19th  
Street SE.

**WHKS & CO.**

*This document was prepared by DCI on 09-30-2013 for use by Cerro Gordo County, Iowa.*