

**Cerro Gordo County, Iowa**  
Iowa North Zone (1401)  
Horiz. Datum: **NAD83(NA2011)**  
Vert. Datum: NAVD 1988  
US Survey Feet  
**2013**

Point Name: **406**

**Designation:** G6MC (Set by WHKS & Co. in 2002)

Northing: **3874943.14sft** Easting: **5006387.73sft**

Orthometric Height: **1130.00sft** Ellipsoid Height: **1036.60sft** **Geoid12A**

Latitude: **N43°07'47.25710"** Longitude: **W93°10'51.86914"**

Mapping Angle: **0°12'58"** Combination Scale Factor: **0.999928405**

**Monument Type:** 5/8" x 6'-0" long aluminum rod with cap stamped G6MC and NGS style access cover 3" deep.

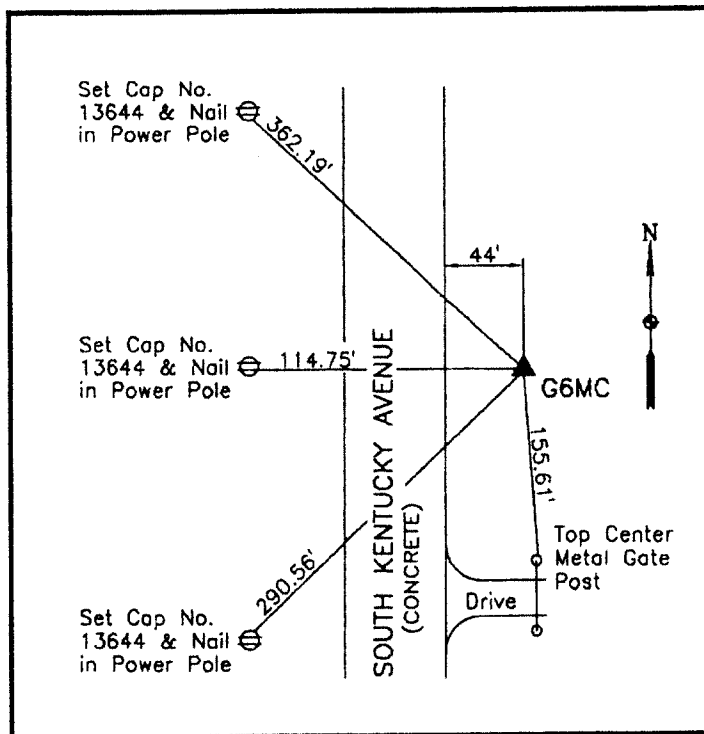

On east side South Kentucky Avenue - 0.2± mile south of 19th Street SE.

**WHKS & CO.**

*This document was prepared by DCI on 09-30-2013 for use by Cerro Gordo County, Iowa.*