

Cerro Gordo County, Iowa
Iowa North Zone (1401)
Horiz. Datum: **NAD83(NA2011)**
Vert. Datum: NAVD 1988
US Survey Feet
2013

Point Name: **412**

Designation: G12MC (Set by WHKS & Co. in 2002)

Northing: **3881636.25sft** Easting: **5001014.77sft**

Orthometric Height: **1112.79sft** Ellipsoid Height: **1019.71sft** **Geoid12A**

Latitude: **N43°08'53.55936"**

Longitude: **W93°12'04.00681"**

Mapping Angle: **0°12'09"**

Combination Scale Factor: **0.999931856**

Monument Type: 5/8" x 6'-0" long aluminum rod with cap stamped G12MC and NGS style access cover 3" deep.

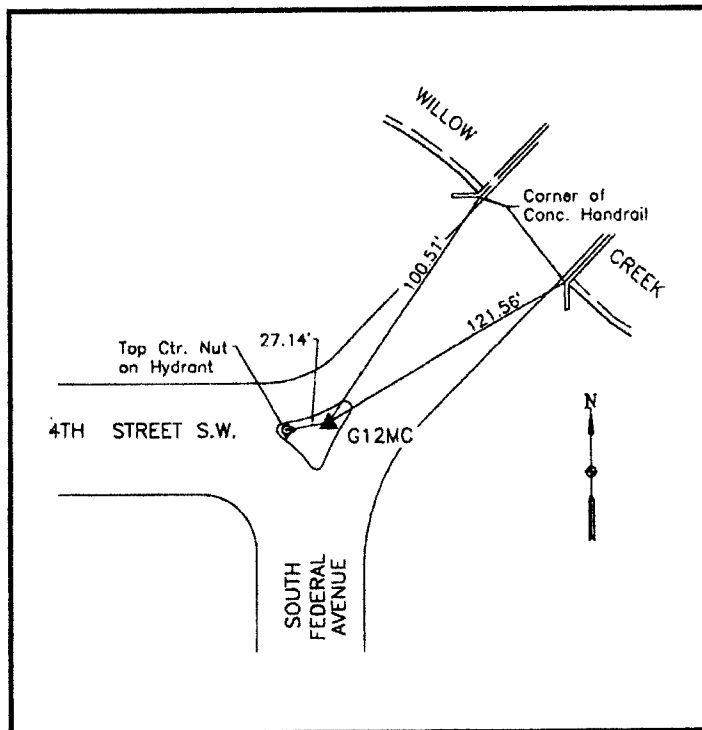

In triangle in intersection of
South Federal Avenue and 4th
Street SW - 18'± north and
18'± east of fire hydrant.

WHKS & CO.

This document was prepared by DCI on 09-30-2013 for use by Cerro Gordo County, Iowa.