

Cerro Gordo County, Iowa
 Iowa North Zone (1401)
 Horiz. Datum: **NAD83(NA2011)**
 Vert. Datum: NAVD 1988
 US Survey Feet
2013

Point Name: **420**

Designation: G20MC (Set by WHKS & Co. in 2002)

Northing: **3891944.98sft** Easting: **5003607.77sft**

Orthometric Height: **1106.83sft** Ellipsoid Height: **1013.62sft** **Geoid12A**

Latitude: **N43°10'35.28664"** Longitude: **W93°11'28.52084"**

Mapping Angle: **0°12'33"** Combination Scale Factor: **0.999936406**

Monument Type: 5/8" x 6'-0" long aluminum rod with cap stamped G20MC and NGS style access cover 2" deep.

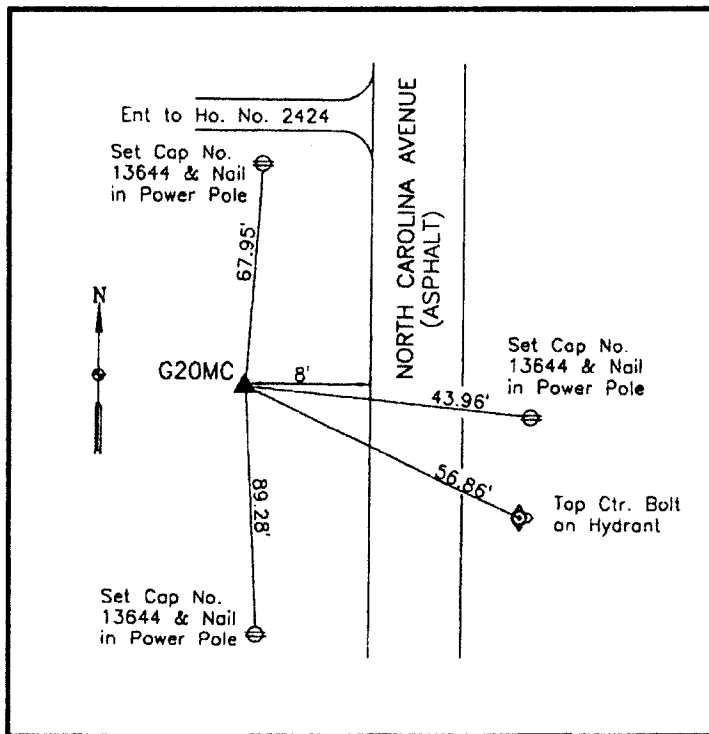

West side North Carolina Avenue - near Southeast Corner Property House No. 2424 - 1.0± mile north of 12th Street NE.

WHKS & CO.

This document was prepared by DCI on 09-30-2013 for use by Cerro Gordo County, Iowa.