

Cerro Gordo County, Iowa
 Iowa North Zone (1401)
 Horiz. Datum: **NAD83(NA2011)**
 Vert. Datum: NAVD 1988
 US Survey Feet
2013

Point Name: **425 (Replaces 413)**

Designation: 2013-425 GPS Control Pt. (Set by DCI in 2013)

Northing: **3881595.22sft** Easting: **4994665.16sft**

Orthometric Height: **1128.63sft** Ellipsoid Height: **1035.80sft** **Geoid12A**

Latitude: **N43°08'53.36700"**

Longitude: **W93°13'29.66151"**

Mapping Angle: **0°11'11"**

Combination Scale Factor: **0.999931080**

Monument Type: Berntsen Top Security Rod Monument with a 2-1/2" dia. domed survey cap and permanent magnet encased in a white PVC pipe with a NGS style aluminum access cover.

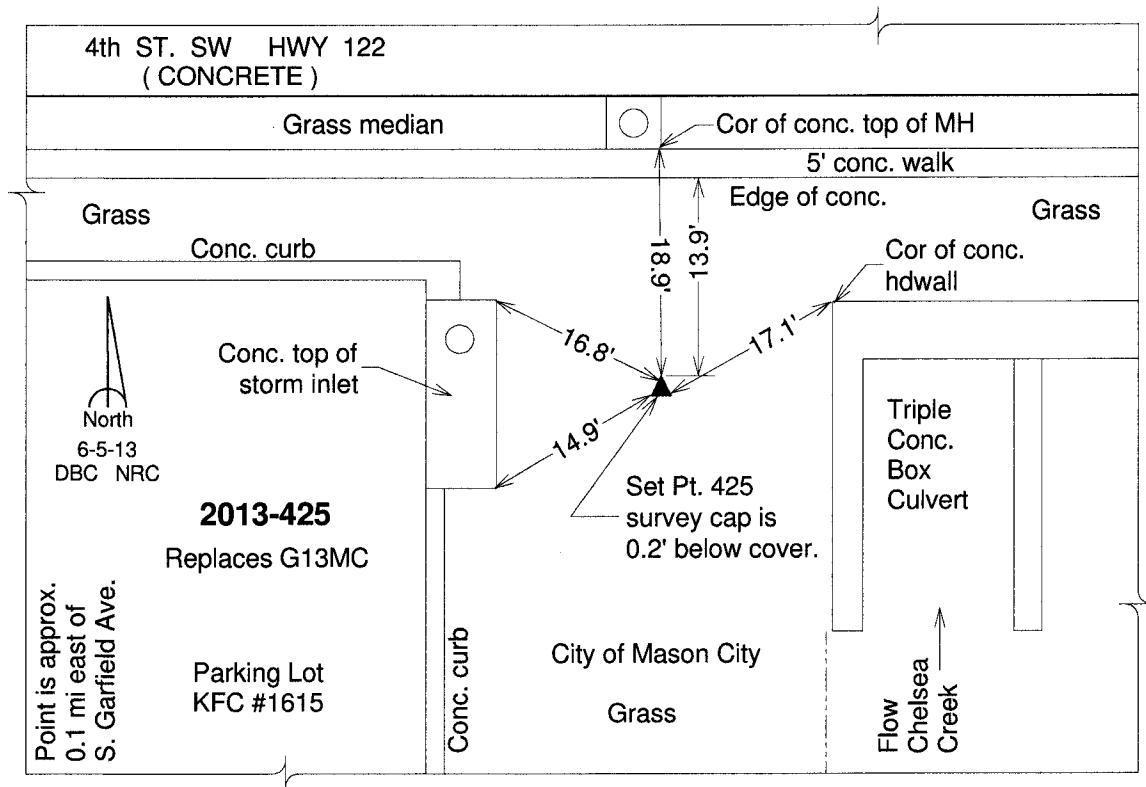

This document was prepared by DCI on 09-30-2013 for use by Cerro Gordo County, Iowa.