

Cerro Gordo County, Iowa
Iowa North Zone (1401)
Horiz. Datum: **NAD83(NA2011)**
Vert. Datum: NAVD 1988
US Survey Feet
2013

Point Name: **514**

Designation: CBN 2nd order vertical station "N 40" PID:OO0274

Northing: **3950068.25sft** Easting: **5086712.02sft**

Orthometric Height: **1192.45sft** Ellipsoid Height: **1094.68sft** **Geoid12A**

Latitude: **N43°20'04.82996"** Longitude: **W92°52'41.22729"**

Mapping Angle: **0°25'17"** Combination Scale Factor: **0.999960907**

Monument Type: The station is a CGS survey disk stamped "N 40 1934" and set in the top of a concrete monument.

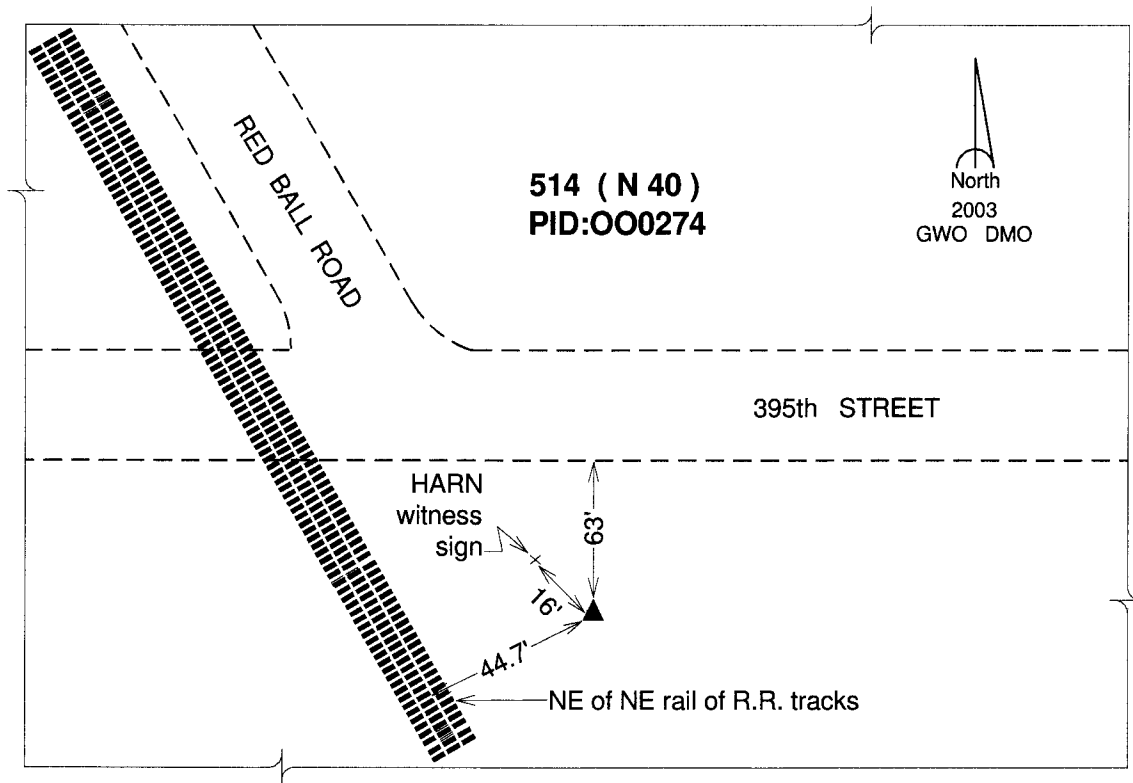

This document was prepared by DCI on 09-30-2013 for use by Cerro Gordo County, Iowa.