

2000
Cherokee County, Iowa
Iowa North Zone (1401)
NAD_83(1996)

Point Number: 26

Northing: 3802182.66(Ft) Easting: 4336265.35(Ft)

Northing: 1158907.592(M) Easting: 1321696.322(M)

Elev: 1378.24(Ft) NAVD_88

Elev: 420.087(M) NAVD_88 Ellip Ht: 392.752(M) 96C Geoid Ht: -27.335(M)

Latitude: 42-54-35.516863 N Longitude: 95-41-01.787320 W

Theta: -1-28-48.28 Combination Factor: 0.99989265

Designation: **CHEROKEE CO GPS CONTROL PT 2000-026**

Monument Type: 5/8" dia driven aluminum rod with a 2-1/2" dia aluminum cap and permanent magnet encased in a 5" dia PVC pipe with an aluminum access cover.

To Reach: 30ft South of 420th St, 0.1mile West of "J" Ave (L48), 0.1mile West of NE Cor of Sec 4, T93N, R41W

Date Printed August 29, 2000

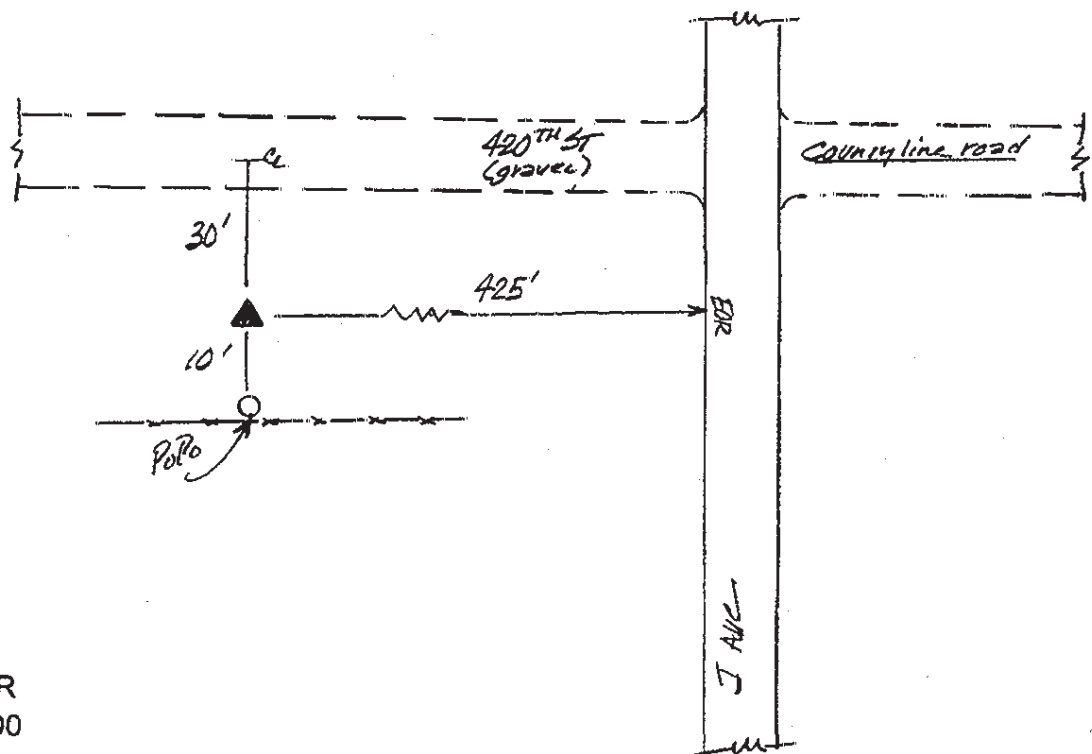

026
RKE/JJR
April 2000