

2000
Cherokee County, Iowa
Iowa North Zone (1401)
NAD_83(1996)

Point Number: 29

Northing: 3706940.13(Ft) Easting: 4349980.67(Ft)

Northing: 1129877.611(M) Easting: 1325876.759(M)

Elev: 1188.53(Ft) NAVD_88

Elev: 362.263(M) NAVD_88 Ellip Ht: 334.735(M) 96C Geoid Ht: -27.529(M)

Latitude: 42-38-58.461266 N Longitude: 95-37-25.393571 W

Theta: -1-26-21.62 Combination Factor: 0.99989289

Designation: **CHEROKEE CO GPS CONTROL PT 2000-029**

Monument Type: 5/8" dia driven aluminum rod with a 2-1/2" dia aluminum cap and permanent magnet encased in a 5" dia PVC pipe with an aluminum access cover.

To Reach: 35ft SE of L56, 200ft West of Section Line Near the SE Cor of Sec 36, T91N, R41W

Date Printed August 29, 2000

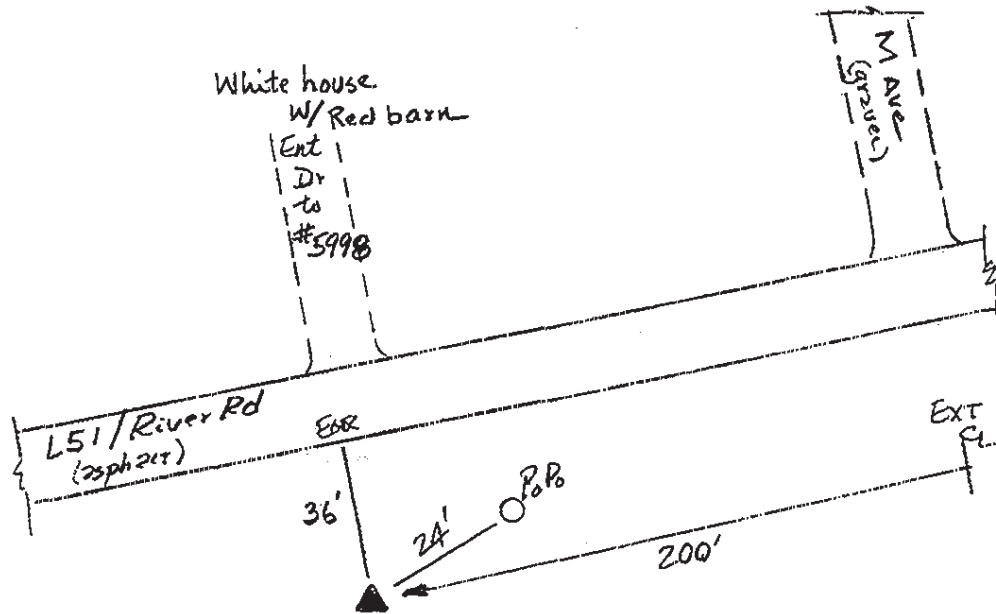

029
RKE/JJR
April 2000