

2001
Floyd, Chickasaw & Howard Counties, Iowa
Iowa North Zone (1401)
NAD_83(1996)

Point Number: **206**

Northing: **3826847.07**(Ft) Easting: **5174251.54**(Ft)

Northing: **1166425.321**(M) Easting: **1577115.025**(M)

Elev: **983.21**(Ft) NAVD_88

Elev: **299.682**(M) NAVD_88 Ellip Ht: **268.608**(M) 96C Geoid Ht: **-31.074**(M)

Latitude: **42-59-39.80314** N Longitude: **92-33-15.51151** W

Theta: **0-38-27.37** Combination Factor: **0.99991945**

Designation: **CHICKASAW CO GPS CONTROL PT 2000-206**

Monument Type: 5/8" dia driven aluminum rod with a 2-1/2" dia aluminum cap and permanent magnet encased in a 5" dia PVC pipe with an aluminum access cover.

To Reach: 60ft N of 250th St., 30ft W of Addison Ave near the SE Cor of Sec 36 T95N R15W.

Date Printed January 17, 2001

4 206
N
Oct 2000

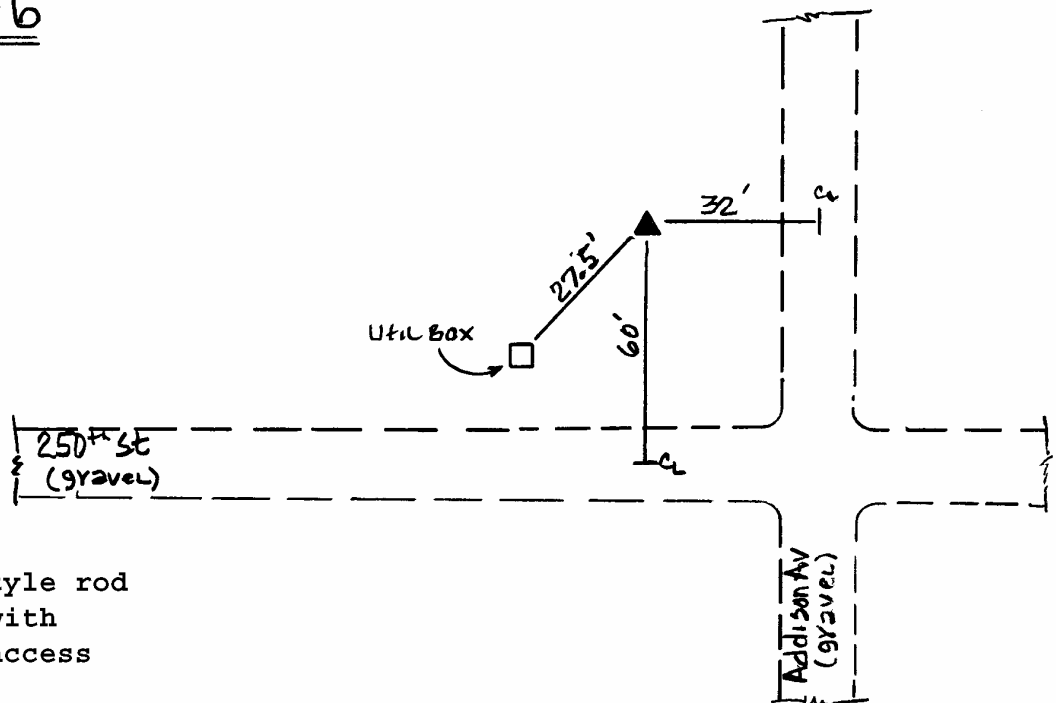

Set NGS style rod
monument with
aluminum access
cover.