

2001  
Floyd, Chickasaw & Howard Counties, Iowa  
Iowa North Zone (1401)  
NAD\_83(1996)

Point Number: **233**

Northing: **3907265.61**(Ft)      Easting: **5236318.90**(Ft)

Northing: **1190936.941**(M)      Easting: **1596033.192**(M)

Elev: **1218.12**(Ft) NAVD\_88

Elev: **371.284**(M) NAVD\_88      Ellip Ht: **340.866**(M)      96C Geoid Ht: **-30.418**(M)

Latitude: **43-12-46.34032** N      Longitude: **92-19-05.27894** W

Theta: **0-48-03.61**      Combination Factor: **0.99993712**

Designation: **CHICKASAW CO GPS CONTROL PT 2000-233**

**Monument Type:** 5/8" dia driven aluminum rod with a 2-1/2" dia aluminum cap and permanent magnet encased in a 5" dia PVC pipe with an aluminum access cover.

**To Reach:** 150ft W of Lasalle Ave, 25ft S of 100th St. near the NE Cor of Sec 24 T97N R13W.

Date Printed January 17, 2001

4      233  
N  
Oct 2000

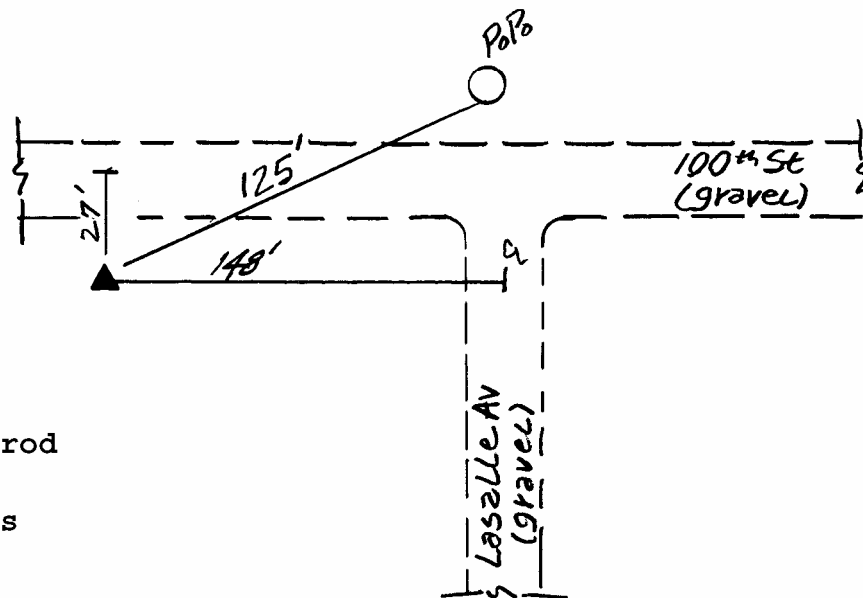

Set NGS style rod  
monument with  
aluminum access  
cover.