

2001  
Floyd, Chickasaw & Howard Counties, Iowa  
Iowa North Zone (1401)  
NAD\_83(1996)

Point Number: **234**

Northing: **3892199.14**(Ft)      Easting: **5236641.66**(Ft)

Northing: **1186344.671**(M)      Easting: **1596131.570**(M)

Elev: **1279.20**(Ft) NAVD\_88

Elev: **389.901**(M) NAVD\_88      Ellip Ht: **359.414**(M)      96C Geoid Ht: **-30.487**(M)

Latitude: **43-10-17.49926** N      Longitude: **92-19-03.76615** W

Theta: **0-48-04.64**      Combination Factor: **0.99992760**

Designation: **CHICKASAW CO GPS CONTROL PT 2000-234**

**Monument Type:** 5/8" dia driven aluminum rod with a 2-1/2" dia aluminum cap and permanent magnet encased in a 5" dia PVC pipe with an aluminum access cover.

**To Reach:** Approx 0.15 mi N of 130th St., 25ft W of Lasalle Ave in the SE 1/4 of Sec 36 T97N R13W.

Date Printed January 17, 2001

234  
4  
N  
Oct 2000

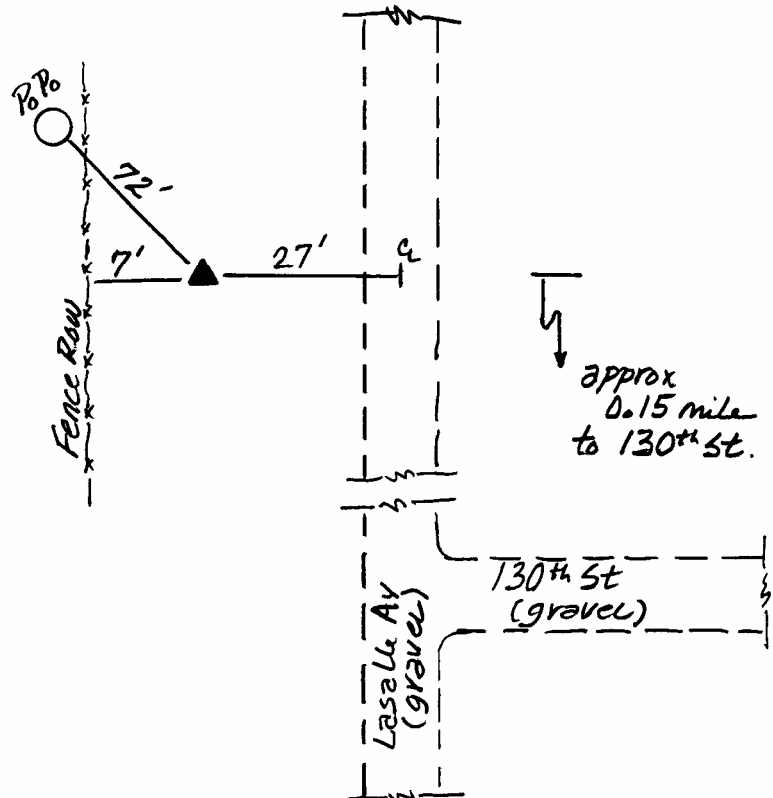

Set NGS style rod  
monument with  
aluminum access  
cover.