

2001
Floyd, Chickasaw & Howard Counties, Iowa
Iowa North Zone (1401)
NAD_83(1996)

Point Number: **269**

Northing: **3844338.81**(Ft) Easting: **5300501.03**(Ft)

Northing: **1171756.812**(M) Easting: **1615595.945**(M)

Elev: **1096.44**(Ft) NAVD_88

Elev: **334.196**(M) NAVD_88 Ellip Ht: **303.655**(M) 96C Geoid Ht: **-30.541**(M)

Latitude: **43-02-15.12412** N Longitude: **92-04-52.96491** W

Theta: **0-57-41.27** Combination Factor: **0.99991852**

Designation: **CHICKASAW CO GPS CONTROL PT 2000-269**

Monument Type: 5/8" dia driven aluminum rod with a 2-1/2" dia aluminum cap and permanent magnet encased in a 5" dia PVC pipe with an aluminum access cover.

To Reach: 125ft S of 220th St., 20ft E of York Ave, near the NW Cor of Sec 19 T95N R10W.

Date Printed January 17, 2001

4
N
Oct 2000

269

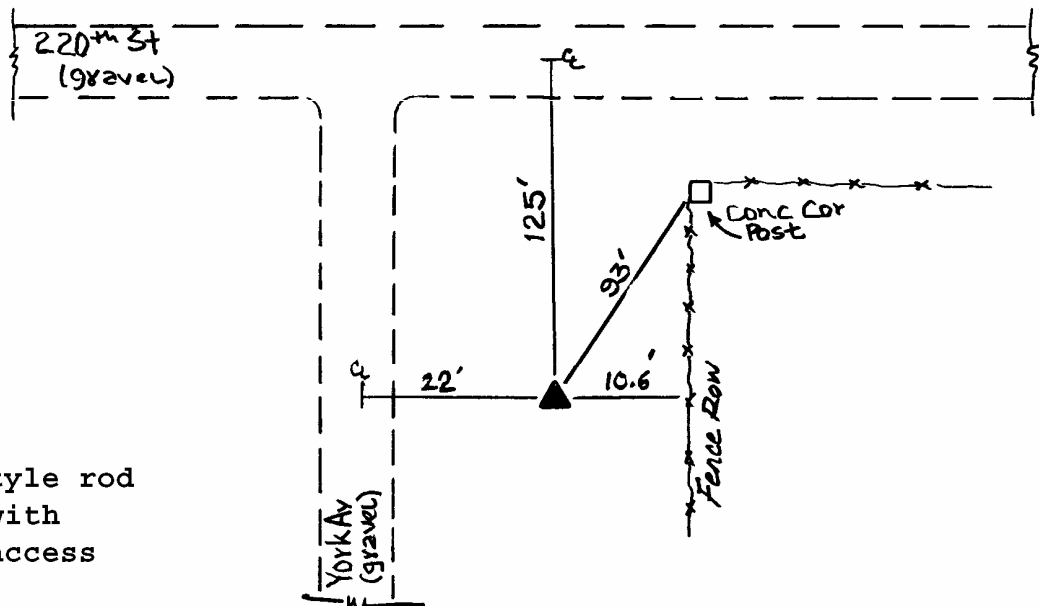

Set NGS style rod
monument with
aluminum access
cover.