

2001
Floyd, Chickasaw & Howard Counties, Iowa
Iowa North Zone (1401)
NAD_83(1996)

Point Number: **271**

Northing: **3812645.75**(Ft) Easting: **5300911.02**(Ft)

Northing: **1162096.748**(M) Easting: **1615720.911**(M)

Elev: **1192.09**(Ft) NAVD_88

Elev: **363.351**(M) NAVD_88 Ellip Ht: **332.686**(M) 96C Geoid Ht: **-30.665**(M)

Latitude: **42-57-02.05008** N Longitude: **92-04-54.60367** W

Theta: **0-57-40.15** Combination Factor: **0.99990533**

Designation: **CHICKASAW CO GPS CONTROL PT 2000-271**

Monument Type: 5/8" dia driven aluminum rod with a 2-1/2" dia aluminum cap and permanent magnet encased in a 5" dia PVC pipe with an aluminum access cover.

To Reach: 30ft N of 280th St., 110ft W of York Ave, near the SE Cor of Sec 13 T94N R11W.

Date Printed January 17, 2001

4
N
Oct 2000

271

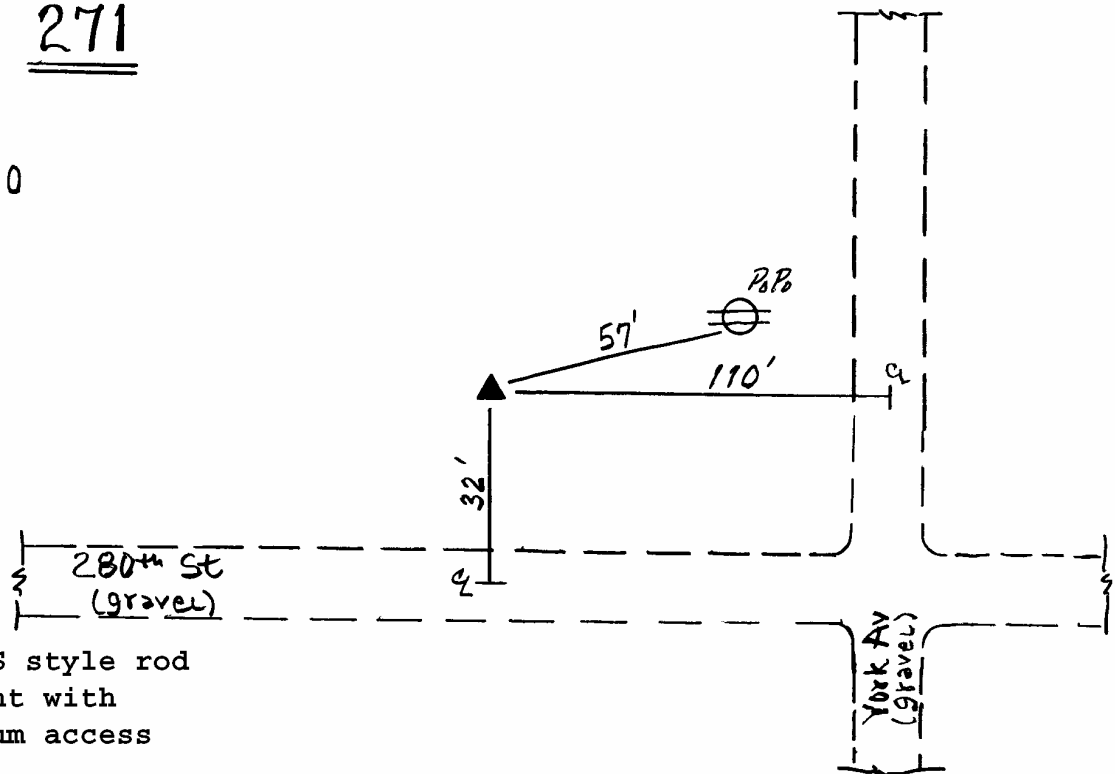

Set NGS style rod
monument with
aluminum access
cover.