

2001  
Floyd, Chickasaw & Howard Counties, Iowa  
Iowa North Zone (1401)  
NAD\_83(1996)

Point Number: **321**

Northing: **3841641.73**(Ft)      Easting: **5079984.71**(Ft)

Northing: **1170934.741**(M)      Easting: **1548382.437**(M)

Elev: **1026.95**(Ft) NAVD\_88

Elev: **313.015**(M) NAVD\_88      Ellip Ht: **282.576**(M)      96C Geoid Ht: **-30.439**(M)

Latitude: **43-02-14.40926** N      Longitude: **92-54-22.55092** W

Theta: **0-24-08.64**      Combination Factor: **0.99992181**

Designation: **FLOYD CO GPS CONTROL PT 2000-321**

**Monument Type:** 5/8" dia driven aluminum rod with a 2-1/2" dia aluminum cap and permanent magnet encased in a 5" dia PVC pipe with an aluminum access cover.

**To Reach:** 120ft W of Glass Ave, 35ft S of 220th St. near the NE Cor of Sec 24 T95N R18W.

Date Printed January 17, 2001

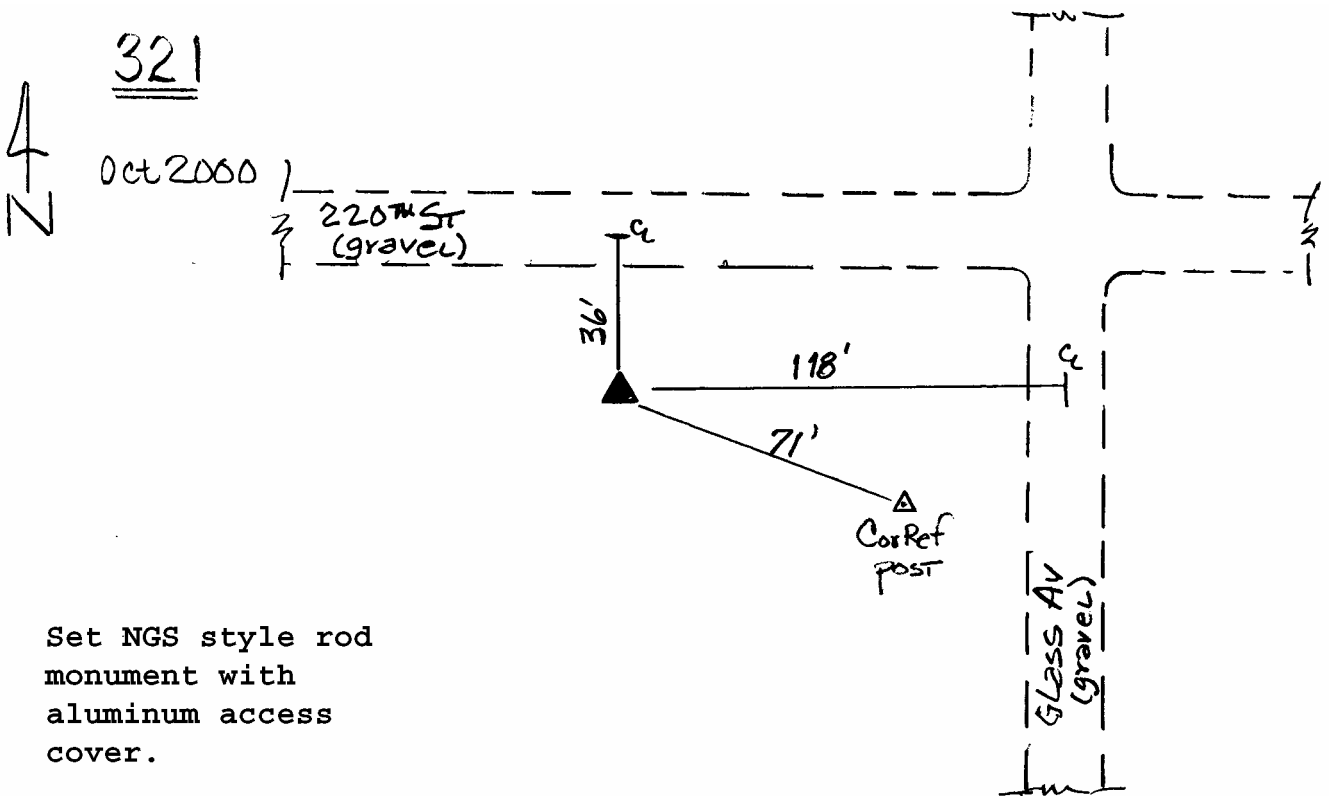

Set NGS style rod  
monument with  
aluminum access  
cover.