

GPS SURVEY MARK DESCRIPTION

GIS MAPPING BY:
THE SIDWELL COMPANY
WEST CHICAGO, ILLINOIS

THE OFFICE OF THE
COUNTY ENGINEER
CLAY COUNTY, IOWA

DESIGNATION 943818 3 GPS No. 7008 COUNTY CLAY STATE IOWA
 LOCATED IN SECTION 18 TWP 94 N RGE 38 W USGS QUAD MAP SUTHERLAND EAST
 TO REACH FROM THE INTERSECTION OF 480TH STREET AND 110TH AVENUE; GO WEST 0.5 MILE TO
105TH STREET; THEN NORTH 0.1 MILE TO DRIVE WEST; THEN WEST 900 FEET, MORE OR LESS, TO MARK,
AT BOB ORTHMANN RESIDENCE WITH PERMISSION.

MARK 3-1/4" ALUMINUM DISK SET IN POURED-IN-PLACE CONCRETE MONUMENT WITH 10" PVC COLLAR

MARK EXISTING VALUES AS PUBLISHED BY _____
 MARK SET VALUES ESTABLISHED BY DENI ASSOCIATES, INC. DATE OCTOBER 1997

HORIZONTAL VALUES ORIGINATED ON ORDER "B" IOWA HIGH ACCURACY REFERENCE NETWORK (HARN) CONTROL ESTABLISHED BY THE NATIONAL GEODETIC SURVEY AND BASED ON THE NORTH AMERICAN DATUM OF 1983, 1996 ADJUSTMENT.

IOWA COORDINATE SYSTEM, NORTH ZONE	SCALE FACTOR: <u>0.99995795</u>
COORDINATES (US FEET)	COORDINATES (METERS)
NORTHING (Y) <u>3816822.578</u>	NORTHING (Y) <u>1163369.849</u>
EASTING (X) <u>4417762.312</u>	EASTING (X) <u>1346536.646</u>

VERTICAL VALUES ORIGINATED ON VERTICAL CONTROL ESTABLISHED BY THE NATIONAL GEODETIC SURVEY AND/OR THE U.S. GEOLOGICAL SURVEY AND BASED ON THE NORTH AMERICAN VERTICAL DATUM OF 1988.

ELEVATION (US FEET) <u>1394.09</u>	ELEVATION (METERS) <u>424.919</u>
------------------------------------	-----------------------------------

- TIES
 No. 1 - 12.5'
 No. 2 - 41.7'
 No. 3 - 40.4'
 No. 4 - 36.0'

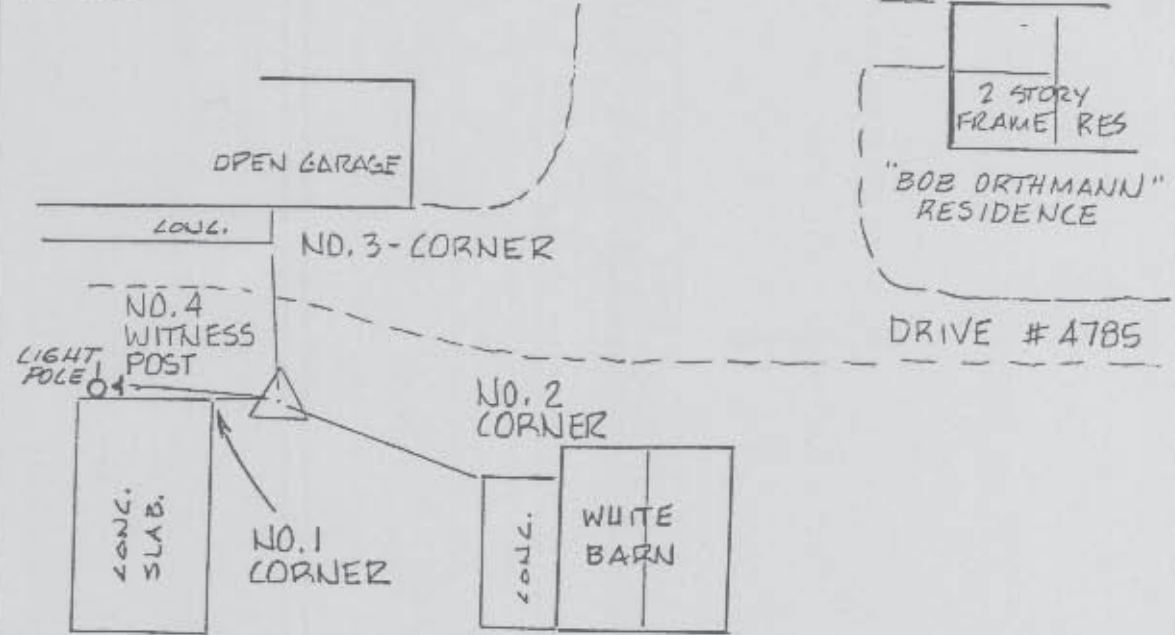

SECTION



SKETCH
 BY DSW
 DENI 9709001