

City of Dubuque, Iowa

07/11/2020

Units: US Survey Feet

Point ID: 104

Stamping on Disk: GPS 104

NAD 83(NA2011) Latitude: N42°31'07.90971" Longitude: W90°38'26.92454"

NAVD 88 Ortho Height: 605.678sft Ellip. Ht: 498.628sft Geoid18(Conus)

Horizontal Datum: NAD 83(NA2011) - Vertical Datum: NAVD 1988

Iowa North Zone (1401) Northing: 3665163.292sft Easting: 5691901.036sft

Mapping Angle: 1°56'16.1" Combination Scale Factor: 0.9999248904

Iowa Regional Coordinate System, Zone 5, Waterloo LCC

IaRCS Zone 5 Northing: 8426755.285sft Easting: 21471022.848sft

Mapping Angle: -0°04'21.5" Combination Scale Factor: 1.0000041236

GPS #104 REFERENCE TIES

GPS #104, PLACED 5/8" X 12'0" ALUMINUM ROD WITH ALUMINUM CAP, STAMPED "GPS 104", AND ACCESS COVER, 6" DEEP, MON. 6" BELOW ACCESS COVER.

ELEV. = 605.605
NAVD - 88

N. 3665163.0664
E. 5691901.1361
U.S. SURVEY FEET
NAD - 83 (1991)

SCALE FACTOR 0.9999248724
CONVERGENCE 01°56'16.08"

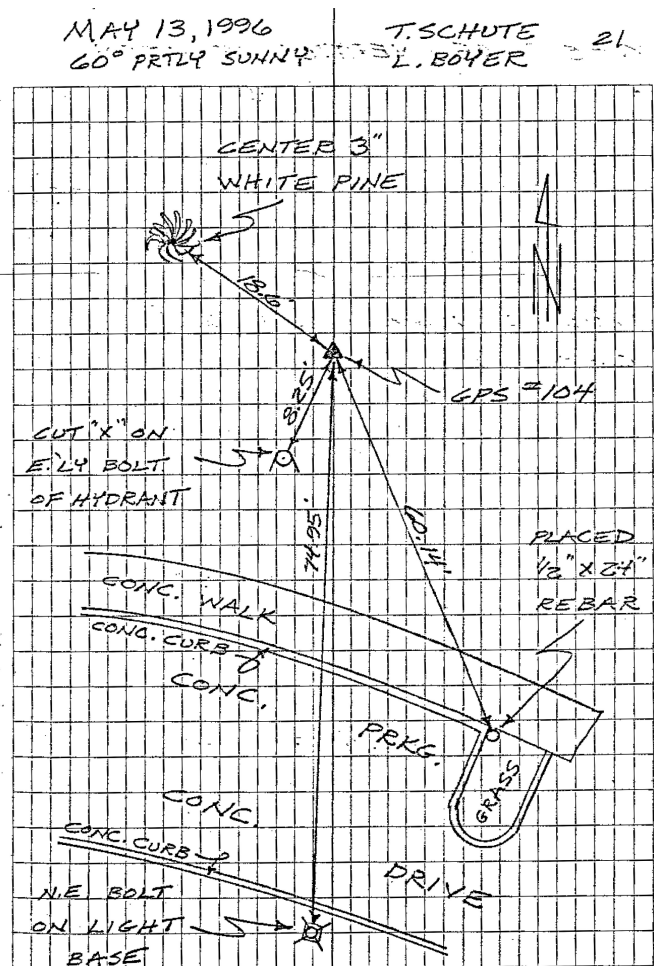

This document was prepared by Dan Corbin, Inc. for The City of Dubuque, Iowa.