

City of Dubuque, Iowa

07/11/2020

Units: US Survey Feet

Point ID: 123

Stamping on Disk: GPS 123

NAD 83(NA2011) Latitude: N42°32'19.63450" Longitude: W90°40'38.70834"

NAVD 88 Ortho Height: 753.520sft Ellip. Ht: 646.622sft Geoid18(Conus)

Horizontal Datum: NAD 83(NA2011) - Vertical Datum: NAVD 1988

Iowa North Zone (1401) Northing: 3672088.375sft Easting: 5681795.590sft

Mapping Angle: 1°54'46.8" Combination Scale Factor: 0.9999169783

Iowa Regional Coordinate System, Zone 5, Waterloo LCC

IaRCS Zone 5 Northing: 8434031.198sft Easting: 21461165.774sft

Mapping Angle: -0°05'50.7" Combination Scale Factor: 0.9999978130

GPS #123	REFERENCE TIES
GPS #123, PLACED 5/8" X 8'0" ALUMINUM ROD WITH ALUMINUM CAP, STAMPED "GPS 123", AND ACCESS COVER, 9" DEEP, MON. 9" BELOW ACCESS COVER.	
ELEV. = 753.515 NAVD - 88	
N. 3672088.0792 E. 5681795.8326 U.S. SURVEY FEET NAD-83(1991)	
SCALE FACTOR 0.999947886 CONVERGENCE 01°54'46.76"	

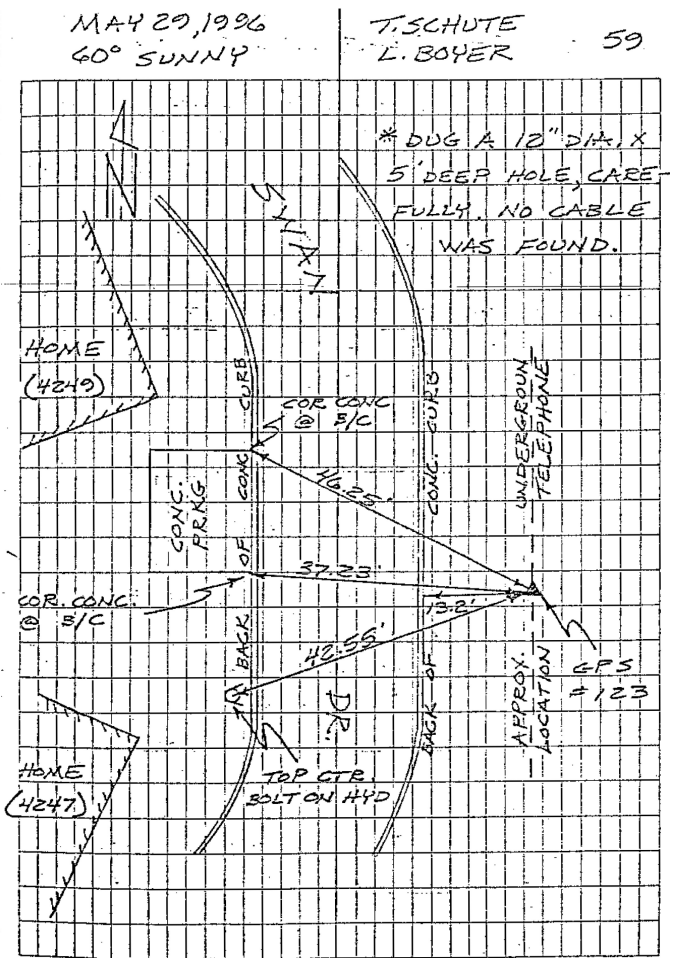

This document was prepared by Dan Corbin, Inc. for The City of Dubuque, Iowa.