

City of Dubuque, Iowa

07/11/2020

Units: US Survey Feet

Point ID: 125

Stamping on Disk: GPS 125

NAD 83(NA2011) Latitude: N42°25'15.58603" Longitude: W90°41'38.45106"

NAVD 88 Ortho Height: 775.342sft Ellip. Ht: 668.805sft Geoid18(Conus)

Horizontal Datum: NAD 83(NA2011) - Vertical Datum: NAVD 1988

Iowa North Zone (1401) Northing: 3629037.012sft Easting: 5678750.182sft

Mapping Angle: 1°54'06.3" Combination Scale Factor: 0.9999226189

Iowa Regional Coordinate System, Zone 5, Waterloo LCC

IaRCS Zone 5 Northing: 8391109.811sft Easting: 21456611.700sft

Mapping Angle: -0°06'30.2" Combination Scale Factor: 0.9999971800

GPS #125	REFERENCE TIES
GPS #125, PLACED 5/8" X 8'0" ALUMINUM ROD WITH ALUMINUM CAP, STAMPED "GPS 125", AND ACCESS COVER, 5" DEEP MON. 7" BELOW ACCESS COVER.	
ELEV. = 775.51 NAVD - 88	
N. 3629037.1672 E. 5678750.5337 U.S. SURVEY FEET NAD-83 (1991)	
SCALE FACTOR 0.999954587 CONVERGENCE 01°54'06.27"	

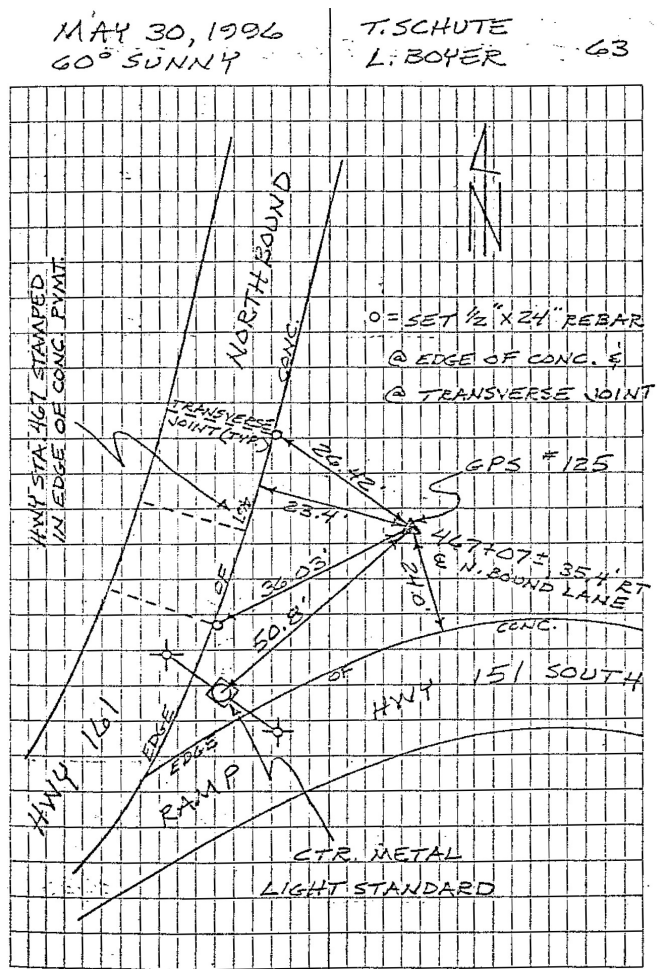

This document was prepared by Dan Corbin, Inc. for The City of Dubuque, Iowa.