

City of Dubuque, Iowa

07/11/2020

Units: US Survey Feet

Point ID: 138

Stamping on Disk: GPS 138

NAD 83(NA2011) Latitude: N42°29'20.67102" Longitude: W90°42'56.96516"

NAVD 88 Ortho Height: 777.557sft Ellip. Ht: 670.957sft Geoid18(Conus)

Horizontal Datum: NAD 83(NA2011) - Vertical Datum: NAVD 1988

Iowa North Zone (1401) Northing: 3653638.616sft Easting: 5672047.736sft

Mapping Angle: 1°53'13.1" Combination Scale Factor: 0.9999181312

Iowa Regional Coordinate System, Zone 5, Waterloo LCC

IaRCS Zone 5 Northing: 8415933.292sft Easting: 21450775.878sft

Mapping Angle: -0°07'23.7" Combination Scale Factor: 0.9999976949

GPS #138	REFERENCE TIES
GPS #138, PLACED 5/8" X 10'6" ALUMINUM ROD WITH ALUMINUM CAP, STAMPED "GPS 138", AND ACCESS COVER, 3" DEEP. MON. 3" BELOW ACCESS COVER.	
ELEV. = 777.73 NAVD - 88	
N. 3653638.4302 E. 5672048.2036 U.S. SURVEY FEET NAD-83 (1991)	
SCALE FACTOR	0.999950202
CONVERGENCE	01°53'13.06"

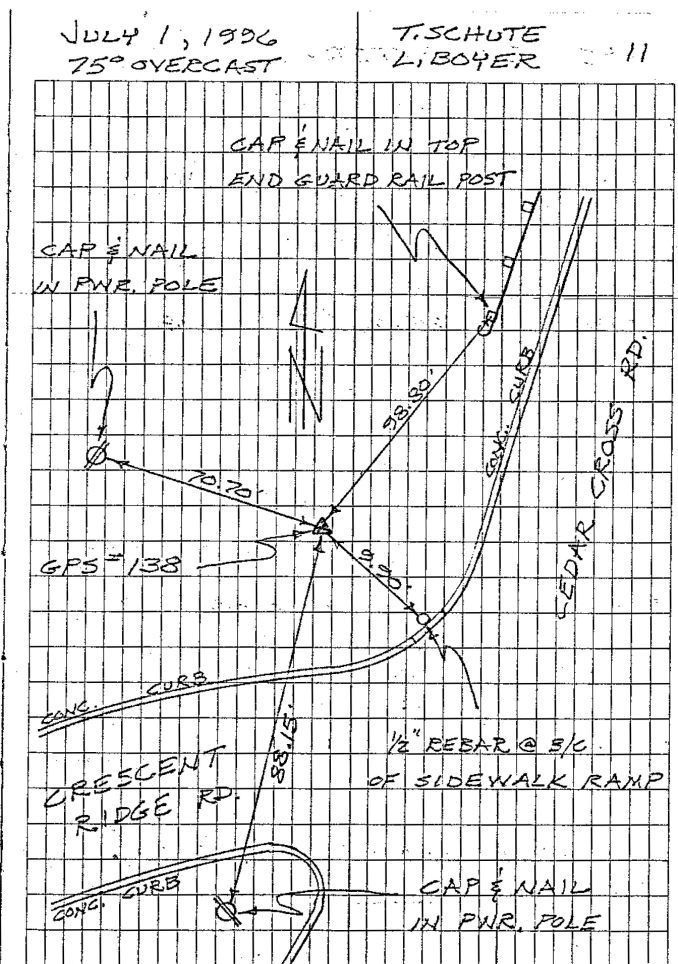

This document was prepared by Dan Corbin, Inc. for The City of Dubuque, Iowa.