

City of Dubuque, Iowa

07/11/2020

Units: US Survey Feet

Point ID: 147

Stamping on Disk: GPS 147

NAD 83(NA2011) Latitude: **N42°30'05.92713"** Longitude: **W90°44'16.10846"**

NAVD 88 Ortho Height: **893.939sft** Ellip. Ht: **787.445sft** Geoid18(Conus)

Horizontal Datum: NAD 83(NA2011) - Vertical Datum: NAVD 1988

Iowa North Zone (1401) Northing: **3658022.951sft** Easting: **5665971.789sft**

Mapping Angle: **1°52'19.4"** Combination Scale Factor: **0.9999119070**

Iowa Regional Coordinate System, Zone 5, Waterloo LCC

IaRCS Zone 5 Northing: **8420528.428sft** Easting: **21444856.988sft**

Mapping Angle: **-0°08'17.3"** Combination Scale Factor: **0.9999928324**

GPS #147	REFERENCE TIES
G.P.S. #147, PLACED 5/8" X 16'0" ALUMINUM ROD WITH ALUMINUM CAP, STAMPED "GPS 147", AND ACCESS COVER, 5" DEEP. MON. 3" BELOW ACCESS COVER.	
ELEV. = 894.09 NAVD-88	
N. 3658022.8517 E. 5665972.2336 U.S. SURVEY FEET NAD-83 (1991)	
SCALE FACTOR 0.999949546 CONVERGENCE 01° 52' 19.42"	

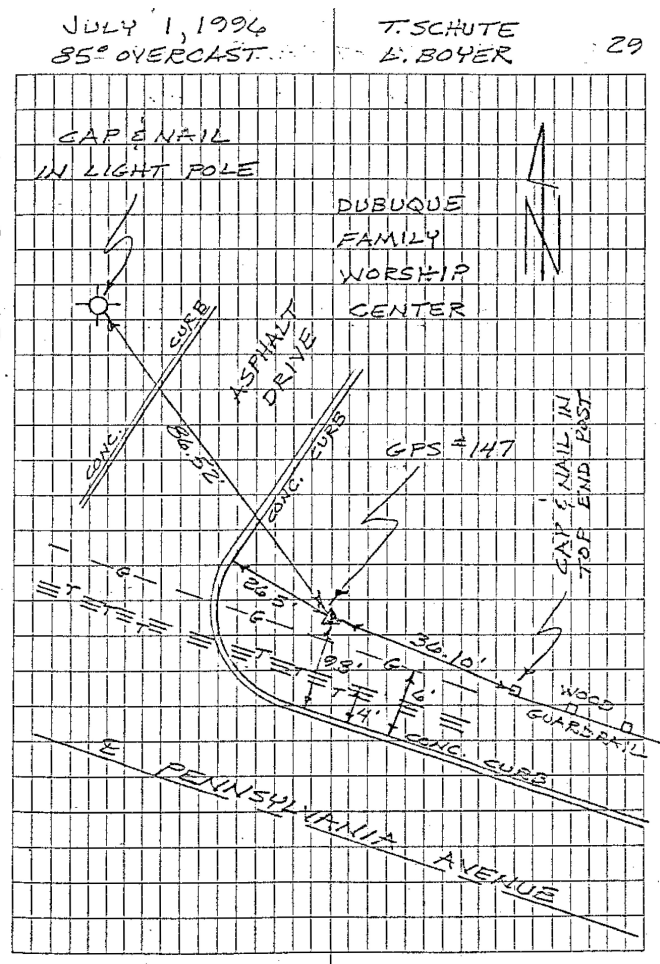

This document was prepared by Dan Corbin, Inc. for The City of Dubuque, Iowa.