

2014 City of West Des Moines, Iowa
Horizontal Datum: **NAD 83(2011)** - Vertical Datum: **NAVD 1988**
Iowa South Zone (1402)
Iowa Regional Coordinate System Zone 8 Ames-Des Moines
US Survey Feet

Point Name: **WDM-HZ #12**

Network Point ID: **2012**

NAD 83(2011) Latitude: **N41°32'26.25462"** Longitude: **W93°47'25.76713"**

NAVD 88 Ortho Height: **835.980sft** Ellip. Ht: **734.135sft** **Geoid12A**

Mapping Angle: **-0°11'29"** Combination Scale Factor: **0.999930885**

Iowa South Zone (1402) Northing: **561440.128sft** Easting: **1560893.076sft**

IaRCS Zone 8 Northing: **7470254.481sft** Easting: **18479788.795sft**

Designation: West Des Moines GPS Control Pt. - WDM-HZ #12

Monument Type: 3/4" x 9'-0" long Berntsen Top Security Rod monument with a 2-1/2" dia. domed survey cap and permanent magnet encased in a white PVC pipe with a NGS style alum. access cover.

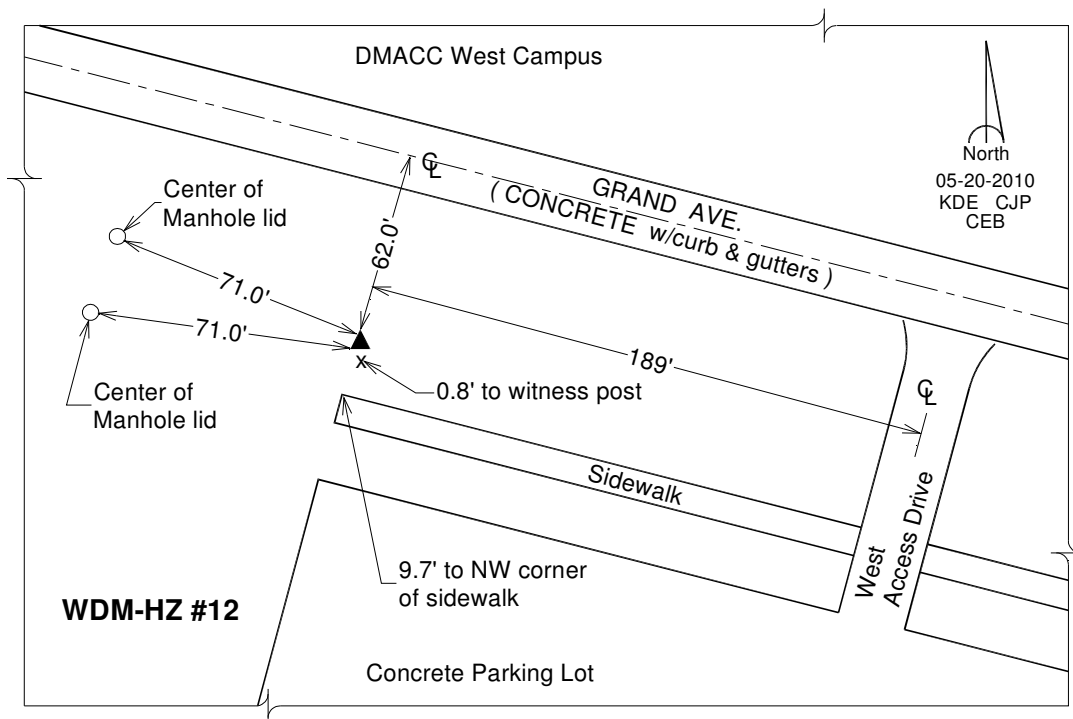

This document was prepared by DCI on June 13, 2014 for use by The City of West Des Moines, Iowa