

2014 City of West Des Moines, Iowa
Horizontal Datum: **NAD 83(2011)** - Vertical Datum: **NAVD 1988**
Iowa South Zone (1402)
Iowa Regional Coordinate System Zone 8 Ames-Des Moines
US Survey Feet

Point Name: **J 33**

Network Point ID: **3004**

NAD 83(2011) Latitude: **N41°42'09.23008"** Longitude: **W93°31'56.00254"**

NAVD 88 Ortho Height: **938.930sft** Ellip. Ht: **836.223sft** **Geoid12A**

Mapping Angle: **-0°01'16"** Combination Scale Factor: **0.999946757**

Iowa South Zone (1402) Northing: **620315.794sft** Easting: **1631617.293sft**

IaRCS Zone 8 Northing: **7529309.994sft** Easting: **18550369.879sft**

Designation: NGS 2nd order vertical control station "J 33" PID: MH0385

Monument Type: A standard CGS bench mark disk stamped "J 33 1934" and set in the southeast corner of a concrete culvert.

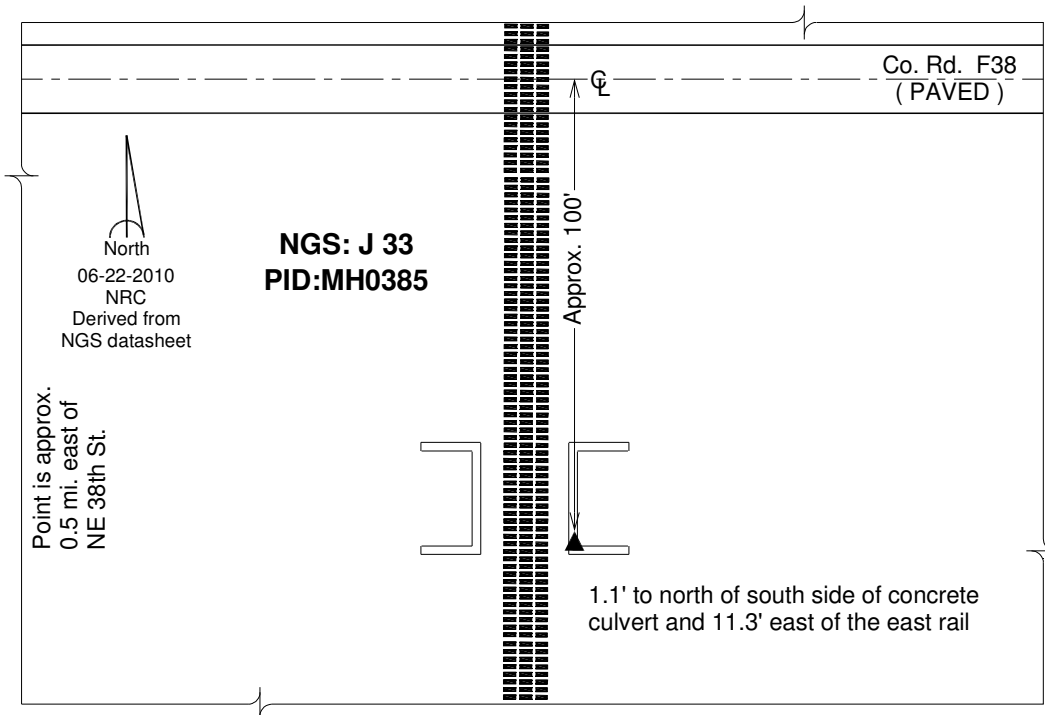

This document was prepared by DCI on June 13, 2014 for use by The City of West Des Moines, Iowa