

**Dallas County, Iowa**

Horizontal Datum: **NAD 83(NA2011)** - Vertical Datum: **NAVD 1988**  
Iowa State Plane South Zone (1402)  
Iowa Regional Coordinate System, Zone 8, Ames-Des Moines TM  
US Survey Feet  
**2018**

Point Name: **105**

**Designation:** G105 (set by WHKS in 2001)

NAD 83(NA2011) Latitude: **N41°30'11.19826"** Longitude: **W94°04'48.83799"**  
NAVD 88 Ortho Height: **1076.997sft** Ellip. Ht: **977.271sft** **Geoid12B**

**Iowa South Zone (1402)** Northing: **548167.874sft** Easting: **1481484.218sft**  
Mapping Angle: **-0°22'56"** Combination Scale Factor: **0.99991562**

**IaRCS Zone 8** Northing: **7456784.735sft** Easting: **18400407.183sft**  
Mapping Angle: **-0°14'27"** Combination Scale Factor: **0.99999770**

**Monument Type:** 5/8" dia. x 6'-0" long alum. rod with cap and NGS style access cover.

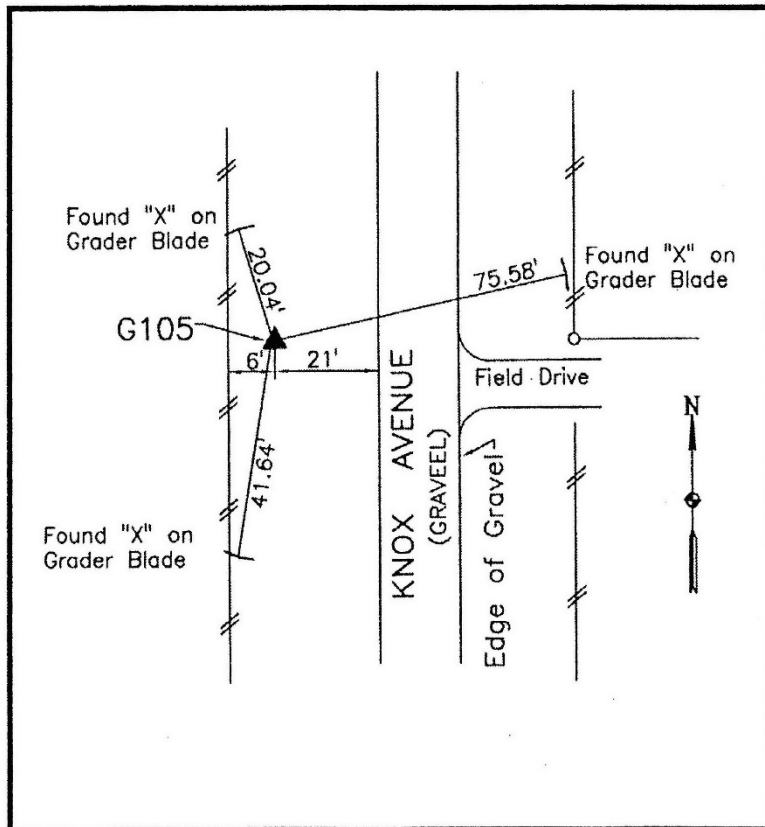

Description:

Placed 5/8" X 6' - 0" Long  
Aluminum Rod with Cap  
Stamped G105 and NGS Style  
Access Cover 4 " Deep.

Location:

West side Knox Avenue at  
south county line. T-78N R-  
28W, S1/4 Cor. Sec. 33.