

Dallas County, Iowa
Horizontal Datum: **NAD 83(NA2011)** - Vertical Datum: **NAVD 1988**
Iowa State Plane South Zone (1402)
Iowa Regional Coordinate System, Zone 8, Ames-Des Moines TM
US Survey Feet
2018

Point Name: **2008**

Designation: WDM-HZ #8 (set by DCI in 2010)

NAD 83(NA2011) Latitude: **N41°33'55.02761"** Longitude: **W93°49'41.35128"**
NAVD 88 Ortho Height: **988.920sft** Ellip. Ht: **887.441sft** Geoid**12B**

Iowa South Zone (1402) Northing: **570461.850sft** Easting: **1550616.753sft**
Mapping Angle: **-0°12'58"** Combination Scale Factor: **0.99992621**

IaRCS Zone 8 Northing: **7479251.253sft** Easting: **18469489.413sft**
Mapping Angle: **-0°04'26"** Combination Scale Factor: **0.99999172**

Monument Type: Berntsen Top Security Rod monument (3/4"dia x 9ft.+) with 2-1/2" aluminum survey cap and permanent magnet encased in a 5" dia. PVC pipe with NGS style alum. access cover.

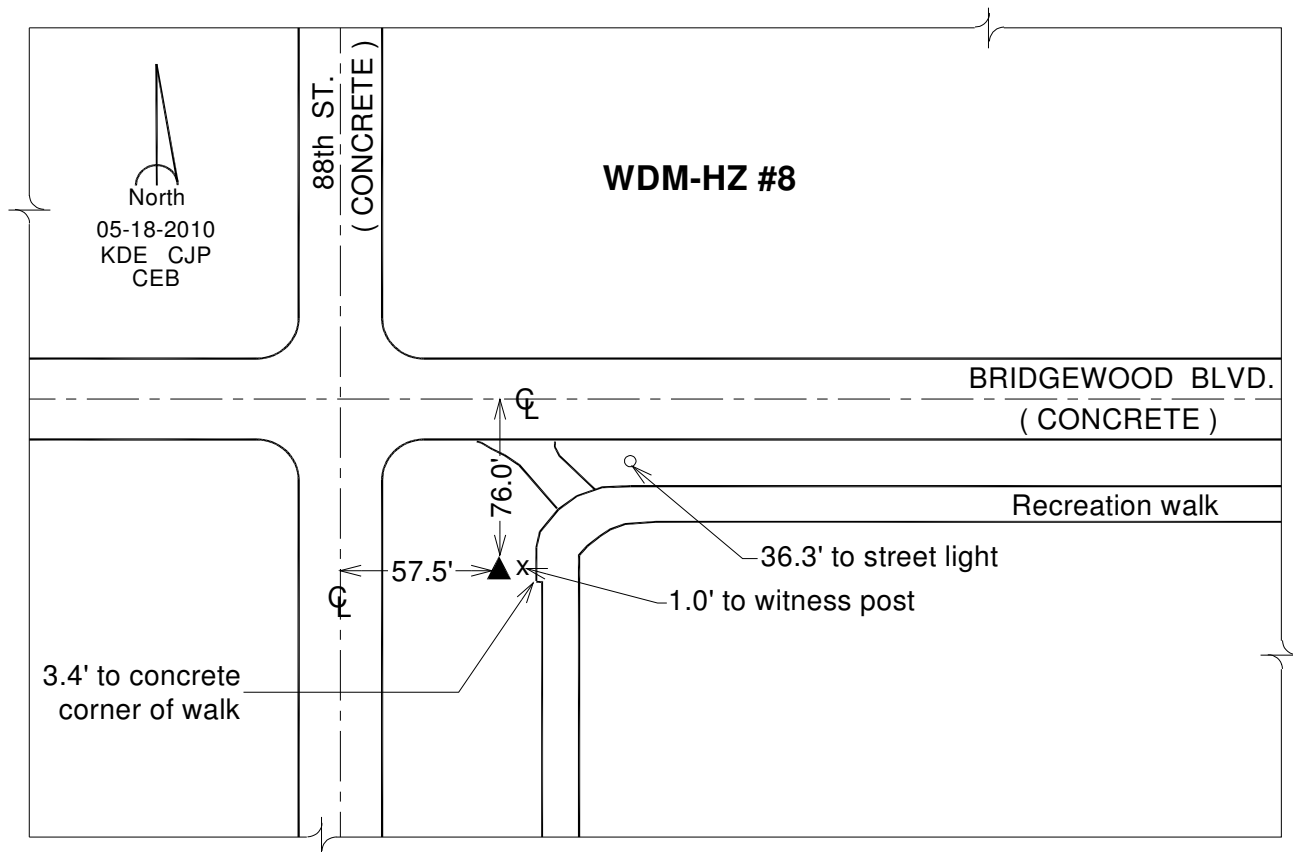

This document was prepared by Dan Corbin, Inc. on March 9, 2018 for Dallas County, Iowa.