

Dallas County, Iowa
Horizontal Datum: **NAD 83(NA2011)** - Vertical Datum: **NAVD 1988**
Iowa State Plane South Zone (1402)
Iowa Regional Coordinate System, Zone 8, Ames-Des Moines TM
US Survey Feet
2018

Point Name: **2015**

Designation: WDM-HZ #15 (set by DCI in 2010)

NAD 83(NA2011) Latitude: **N41°31'11.87788"** Longitude: **W93°54'07.25032"**
NAVD 88 Ortho Height: **859.180sft** Ellip. Ht: **757.984sft** **Geoid12B**

Iowa South Zone (1402) Northing: **554033.775sft** Easting: **1530328.362sft**
Mapping Angle: **-0°15'53"** Combination Scale Factor: **0.99992768**

IaRCS Zone 8 Northing: **7462771.793sft** Easting: **18449240.423sft**
Mapping Angle: **-0°07'22"** Combination Scale Factor: **0.99999978**

Monument Type: Berntsen Top Security Rod monument (3/4"dia x 9ft.+) with 2-1/2" aluminum survey cap and permanent magnet encased in a 5" dia. PVC pipe with NGS style alum. access cover.

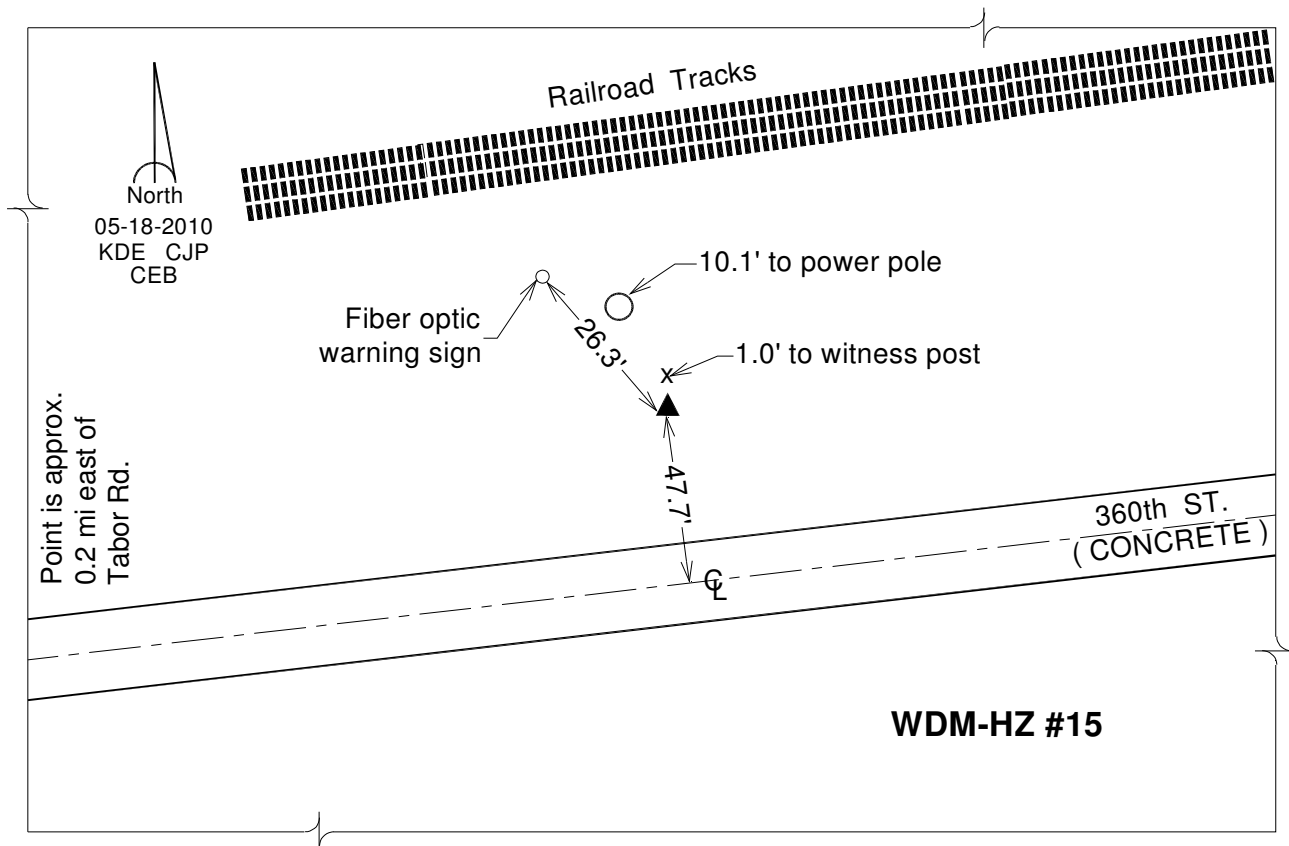

This document was prepared by Dan Corbin, Inc. on March 9, 2018 for Dallas County, Iowa.