

**Dallas County, Iowa**  
 Horizontal Datum: **NAD 83(NA2011)** - Vertical Datum: **NAVD 1988**  
 Iowa State Plane South Zone (1402)  
 Iowa Regional Coordinate System, Zone 8, Ames-Des Moines TM  
 US Survey Feet  
**2018**

Point Name: **37101**

**Designation:** Greene Co. 101 (set by DCI in 2012)

NAD 83(NA2011) Latitude: **N41°51'47.91752"** Longitude: **W94°13'18.70725"**  
 NAVD 88 Ortho Height: **1004.110sft** Ellip. Ht: **912.394sft** **Geoid12B**

**Iowa South Zone (1402)** Northing: **679706.003sft** Easting: **1443780.072sft**  
 Mapping Angle: **-0°28'32"** Combination Scale Factor: **0.99997165**

**IaRCS Zone 8** Northing: **7588238.783sft** Easting: **18362379.499sft**  
 Mapping Angle: **-0°20'14"** Combination Scale Factor: **1.00001111**

**Monument Type:** Berntsen Top Security Rod monument (3/4"dia x 6ft.+) with 2-1/2" domed survey cap and permanent magnet encased in a 5" dia. PVC pipe with NGS style alum. access cover.

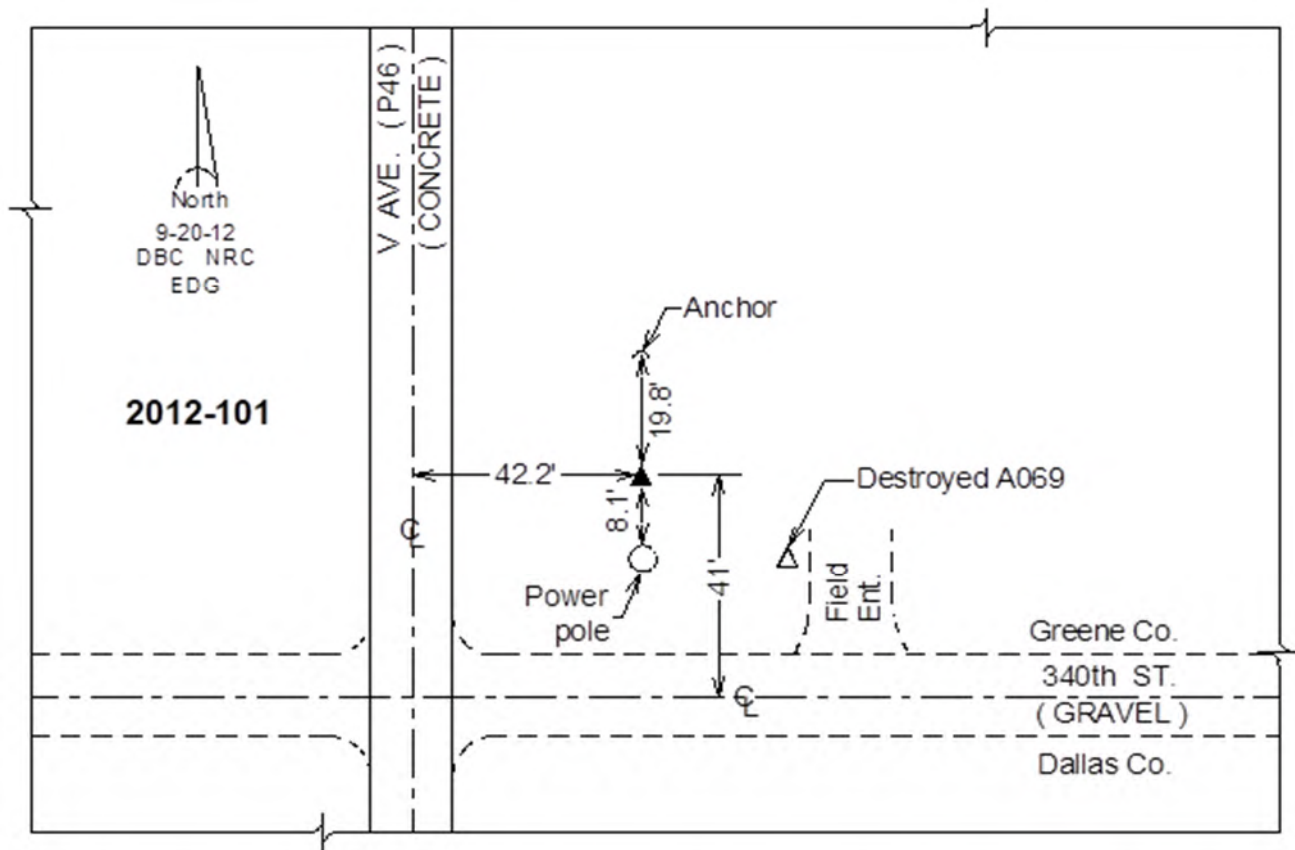

*This document was prepared by Dan Corbin, Inc. on March 9, 2018 for Dallas County, Iowa.*