

2000
Davis & Van Buren Counties, Iowa
Iowa South Zone (1402)
NAD_83(1996)

Point Number: 113

Northing: 221697.38(Ft) Easting: 1943014.01(Ft)

Northing: 67573.495(M) Easting: 592231.854(M)

Elev: 875.44(Ft) NAVD_88

Elev: 266.836(M) NAVD_88 Ellip Ht: 234.102(M) 96C Geoid Ht: -32.734(M)

Latitude: 40-36-11.880277 N Longitude: 92-24-36.890678 W

Theta: 0-43-04.16 Combination Factor: 0.99996565

Designation: DAVIS CO GPS CONTROL PT 2000-113

Monument Type: 5/8" dia driven aluminum rod with a 2-1/2" dia aluminum cap and permanent magnet encased in a 5" dia PVC pipe with an aluminum access cover.

To Reach: Approx. 400ft W of N/S 1/2 section line fence, 20ft N of 312th St. in the NE 1/4 of Sec 13 T67N R14W.

Date Printed July 25, 2000

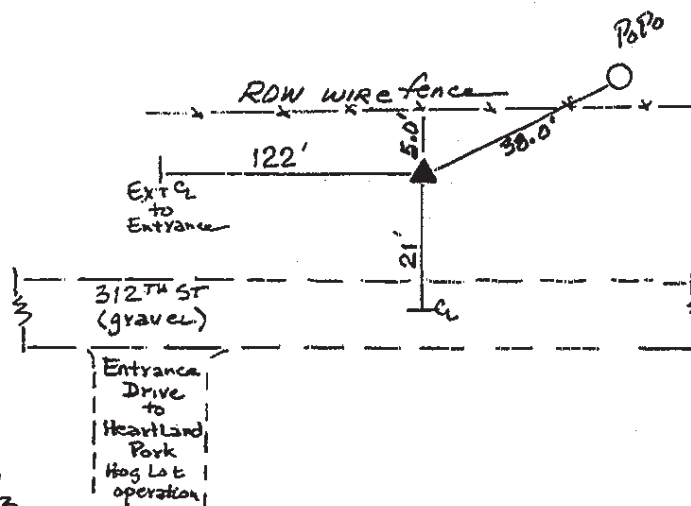

113
BRS/MAIS
APRIL 2000