

2000  
Davis & Van Buren Counties, Iowa  
Iowa South Zone (1402)  
NAD\_83(1996)

Point Number: 131

Northing: 330861.44(Ft)

Easting: 2022902.23(Ft)

Northing: 100846.769(M)

Easting: 616581.831(M)

Elev: 773.30(Ft) NAVD\_88

Elev: 235.704(M) NAVD\_88

Ellip Ht: 202.821(M)

96C Geoid Ht: -32.883(M)

Latitude: 40-53-59.227199 N

Longitude: 92-06-58.801355 W

Theta: 0-54-41.12

Combination Factor: 0.99993028

Designation: VAN BUREN CO GPS CONTROL PT 2000-131

**Monument Type:** 5/8" dia driven aluminum rod with a 2-1/2" dia aluminum cap and permanent magnet encased in a 5" dia PVC pipe with an aluminum access cover.

**To Reach:** 65ft E of Dewberry Ave, 20ft S of Jefferson Van Buren St. in the NW quarter of Sec 3 T70N R11W.

Date Printed July 25, 2000

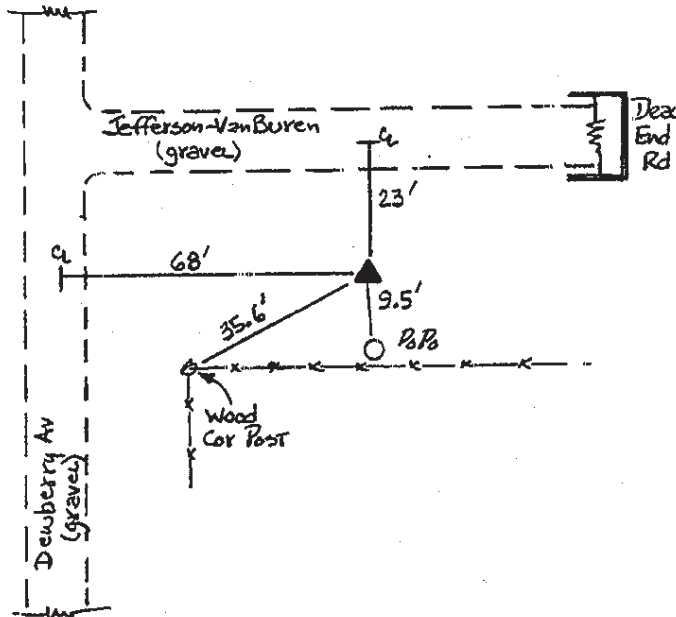

131  
BRS/MAB  
APRIL 2000