

2000
Davis & Van Buren Counties, Iowa
Iowa South Zone (1402)
NAD_83(1996)

Point Number: 136

Northing: 330935.06(Ft) Easting: 2035946.90(Ft)

Northing: 100869.208(M) Easting: 620557.857(M)

Elev: 752.99(Ft) NAVD_88

Elev: 229.515(M) NAVD_88 Ellip Ht: 196.611(M) 96C Geoid Ht: -32.904(M)

Latitude: 40-53-57.869264 N Longitude: 92-04-08.931841 W

Theta: 0-56-33.01 Combination Factor: 0.99993129

Designation: VAN BUREN CO GPS CONTROL PT 2000-136

Monument Type: 5/8" dia driven aluminum rod with a 2-1/2" dia aluminum cap and permanent magnet encased in a 5" dia PVC pipe with an aluminum access cover.

To Reach: 25ft W of V 64 near the E/W Section line, 65ft N of field entr to W in the NE quarter of Sec 1 T70N R11 W.

Date Printed July 25, 2000

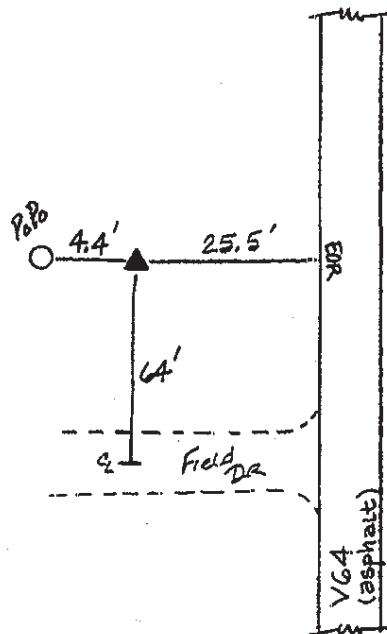

136
BRS/MAB
APRIL 2000