

2000  
Davis & Van Buren Counties, Iowa  
Iowa South Zone (1402)  
NAD\_83(1996)

Point Number: 151

Northing: 227634.51(Ft)      Easting: 2116283.96(Ft)

Northing: 69383.136(M)      Easting: 645044.642(M)

Elev: 701.99(Ft) NAVD\_88

Elev: 213.990(M) NAVD\_88      Ellip Ht: 180.858(M)      96C Geoid Ht: -33.132(M)

Latitude: 40-36-42.946271 N      Longitude: 91-47-09.441960 W

Theta: 1-07-44.55      Combination Factor: 0.99997246

Designation: VAN BUREN CO GPS CONTROL PT 2000-151

**Monument Type:** 5/8" dia driven aluminum rod with a 2-1/2" dia aluminum cap and permanent magnet encased in a 5" dia PVC pipe with an aluminum access cover.

**To Reach:** 130ft N of 300th St., 20ft W of Underwood Ave near the South 1/4 cor Sec 9 T67N R8W.

Date Printed July 25, 2000

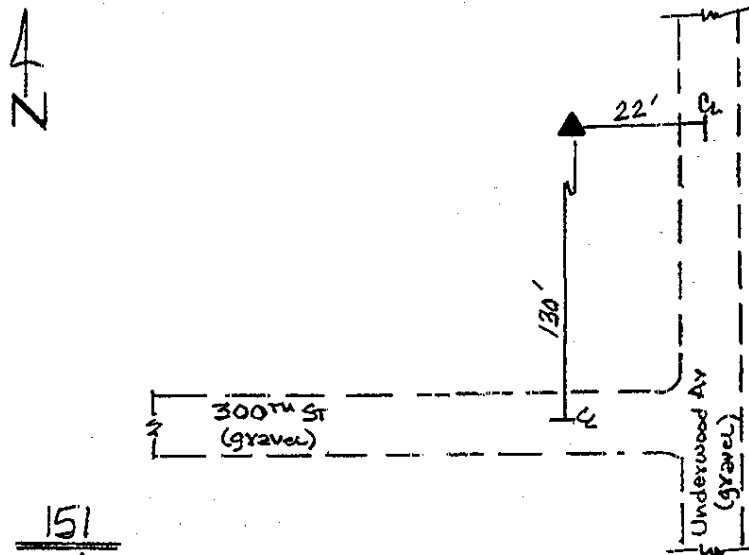

151  
BRS/MAB  
APRIL 2000