

Des Moines County, Iowa  
Iowa South Zone (1402)  
Horiz. Datum: **NAD83(NA2011)**  
Vert. Datum: NAVD 1988  
US Survey Feet  
**2012**

Point Name: **248 (Replaced by 2012-313)**

**Designation:** ~~1999-248 Des Moines County GPS Control Pt. (Set by ASI in 1999)~~

Northing: **304250.35**sft Easting: **2293259.85**sft

Orthometric Height: **694.46**sft Ellipsoid Height: **585.62**sft **Geoid96C**

Latitude: **N40°48'38.868944"** Longitude: **W91°08'28.636518"**

Mapping Angle: **1°33'13"** Combination Scale Factor: **0.99994340**

**Monument Type:** ~~5/8" rebar (No Cap).~~

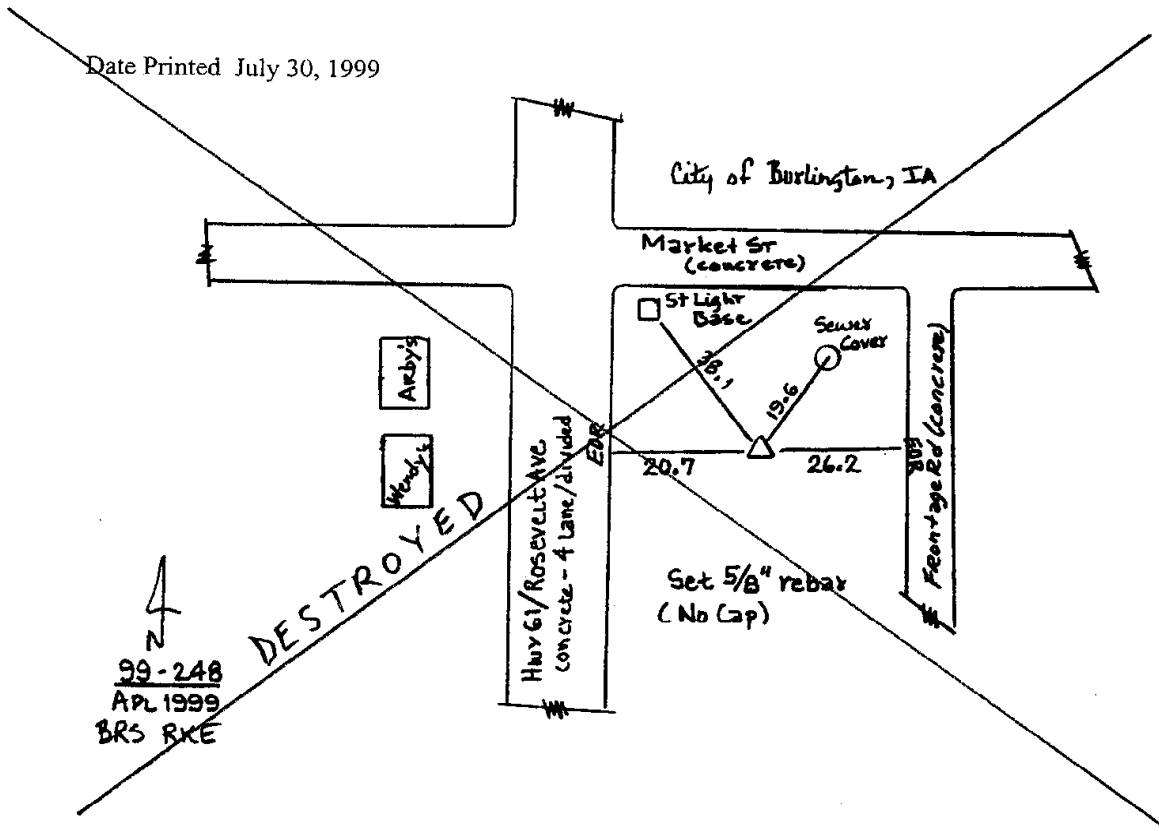

*This document was prepared by DCI and GBC for use by Des Moines County, Iowa.*