

1999
Des Moines County, Iowa
Iowa South Zone (1402)
NAD_83(1996)

Point Number: 300

Northing: 429991.62(Ft) Easting: 2194949.24(Ft)

Northing: 131061.708(M) Easting: 669021.867(M)

Elev: 691.44(Ft) NAVD_88

Elev: 210.750(M) NAVD_88 Ellip Ht: 177.830(M) 96C Geoid Ht: -32.920(M)

Latitude: 41-09-45.353290 N Longitude: 91-29-08.977910 W

Theta: 1-19-36.26 Combination Factor: 0.99992069

Designation: WASHINGTON CO GPS No. 96-167

Monument Type: 5/8" dia driven aluminum rod with a 2-1/2" dia aluminum cap and permanent magnet encased in a 5" dia PVC pipe with an aluminum access cover.

To Reach: 25ft W of Louisa-Washington Rd, 75ft N of Louisa-Henry St near the SE cor Sec 36 T74N R6W

Date Printed July 30, 1999

Set NGS Style
Rod Monument
With Access Cover

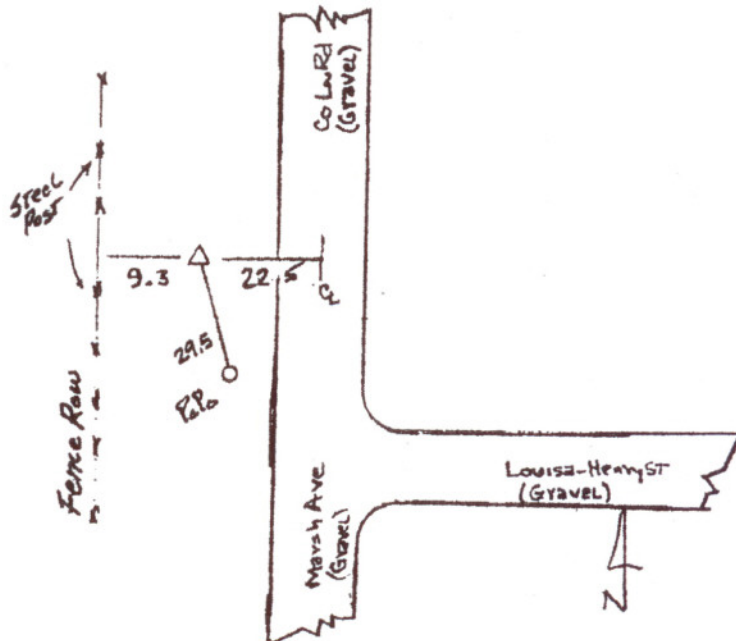

167
RKE KRR